



Annual Report Form For Individual NPDES Permits For Municipal Separate Storm Sewer Systems (RULE 62-624.600(2), F.A.C.)

- This Annual Report Form must be completed and submitted to the Department to satisfy the annual reporting requirements established in Rule 62-621.600, F.A.C.
- Submit this fully completed and signed form and any REQUIRED attachments by email to the NPDES Stormwater Program Administrator or to the MS4 coordinator (<http://www.dep.state.fl.us/water/stormwater/npdes/contacts.htm>). Files larger than 10MB may be placed on the FTP site at: ftp://ftp.dep.state.fl.us/pub/NPDES_Stormwater/. After uploading files, email the MS4 coordinator or NPDES Program Administrator to notify them the report is ready for downloading; or by mail to the address in the box at right.
- Refer to the Form Instructions for guidance on completing each section.
- **Please print or type information in the appropriate areas below.**

Submit the form and attachments to:
 Florida Department of Environmental Protection
 Mail Station 3585
 2600 Blair Stone Road
 Tallahassee, Florida 32399-2400

SECTION I. BACKGROUND INFORMATION

A.	Permittee Name: Town of Lake Clark Shores		
B.	Permit Name: Palm Beach County MS4		
C.	Permit Number: FLS000018-004		
D.	Annual Report Year: <input checked="" type="checkbox"/> Year 1 <input type="checkbox"/> Year 2 <input type="checkbox"/> Year 3 <input type="checkbox"/> Year 4 <input type="checkbox"/> Year 5 <input type="checkbox"/> Other, specify Year:		
E.	Reporting Time Period (month/year): 10 / 2016 through 9 / 2017		
F.	Name of the Responsible Authority: Daniel Clark		
	Title: Town Administrator		
	Mailing Address: 1701 Barbados Road		
	City: Lake Clark Shores	Zip Code: 33406	County: Palm Beach
	Telephone Number: 561-964-1515		Fax Number: 561-964-0685
	E-mail Address: dclark@lakeclarke.org		
G.	Name of the Designated Stormwater Management Program Contact (if different from Section I.F above): Damon Gammons		
	Title: Utilities Superintendent		
	Department: Public Works		
	Mailing Address: 1701 Barbados Road		
	City: Lake Clarke Shores	Zip Code: 33406	County: Palm Beach
	Telephone Number: 561-642-7870		Fax Number: 561-964-0685
E-mail Address: dgammons@lakeclarke.org			

SECTION II. MS4 MAJOR OUTFALL INVENTORY (Not Applicable in Year 1)

A.	Number of outfalls ADDED to the outfall inventory in the current reporting year (insert "0" if none): (Does this number include non-major outfalls? <input type="checkbox"/> Yes <input type="checkbox"/> No <input checked="" type="checkbox"/> Not Applicable)
B.	Number of outfalls REMOVED from the outfall inventory in the current reporting year (insert "0" if none): (Does this number include non-major outfalls? <input type="checkbox"/> Yes <input type="checkbox"/> No <input checked="" type="checkbox"/> Not Applicable)
C.	Is the change in the total number of outfalls due to lands annexed or vacated? <input type="checkbox"/> Yes <input type="checkbox"/> No <input checked="" type="checkbox"/> Not Applicable

SECTION III. PART V.B. ASSESSMENT PROGRAM

A.	<p>Provide a brief statement as to the status of water quality monitoring plan implementation. Status may include sampling frequency changes, monitoring location changes, or sampling waiver conditions. <i>DEP Note: If permittee participates in a collaborative monitoring plan, permittee may refer to a joint response as defined by the interlocal agreement.</i></p> <p>Name and date of the approved plan: Current approved plan for the Group Monitoring Plan is September 8, 2016 (with issuance of the Cycle 4 permit.) Our newly-developed, individual Assessment Plan was submitted on 9/8/2017. Status: The Group Monitoring Report is included in Cycle 4, Year 1 Joint Annual Report. The newly-developed, individual Assessment Plan is awaiting approval by FDEP.</p>
B.	<p>Provide a brief discussion of the monitoring and loading results to date which includes a summary of the water quality monitoring data and / or stormwater pollutant loading changes from the reporting year. <i>DEP Note: Results must be specific to the permittee's SWMP.</i></p> <p>Please refer to the Cycle 4, Year 1 Joint Annual Report for a summary of the Group's water quality monitoring results for the reporting period. Refer to the Cycle 3, Year 6 Joint Annual Report for proposed pollutant loading analysis changes. The best available information on existing pollutant loading estimates is documented in the Cycle 3, Year 3 Joint Annual Report. The newly-developed, individual Assessment Plan is under review by FDEP and will be implemented during Year 2 of the permit cycle. Note that in any future reporting year, the Group's water quality monitoring data for the reporting period may not be available for 4 to 6 months after the reporting period has ended. Consequently, any water quality data from the Group Program that is used as part of an individual permittee's Assessment Plan for the reporting period, will be based on the previous year's data.</p>
C.	<p>Attach a monitoring data summary as required by the permit. An analysis of the data discussing changes in water quality and/or stormwater pollutant loading from previous reporting years. <i>DEP Note: Analysis must be specific to the permittee's SWMP.</i></p> <p>See response for Section III.B. above.</p>

SECTION IV. FISCAL ANALYSIS

A.	Total expenditures for the NPDES stormwater management program for the current reporting year: \$5,500
B.	Total budget for the NPDES stormwater management program for the subsequent reporting year: \$28,707
C.	<p>Did the current reporting year resources decrease from the previous year? Y <input type="checkbox"/> / N <input checked="" type="checkbox"/></p> <p>If program resources decreased, provide a discussion of the impacts on the implementation of the SWMP.</p> <p>Note: External consulting fees decreased slightly from last year.</p>

SECTION V. MATERIALS TO BE SUBMITTED WITH THIS ANNUAL REPORT FORM

Only the following materials are to be submitted to the Department along with this fully completed and signed Annual Report Form (check the appropriate box to indicate whether the item is attached or is not applicable):

Attached	N/A	Required Attachments	Permit Citation	Attachment Number/Title
<input type="checkbox"/>	<input checked="" type="checkbox"/>	Any additional information required to be submitted in this current annual reporting year in accordance with Part III.A of your permit that is not otherwise included in Section VII below.	Part III.A	
<input type="checkbox"/>	<input checked="" type="checkbox"/>	An explanation of why the minimum inspection frequency in Table II.A.1.a. was not met, if applicable.	Part II.A.1	
<input type="checkbox"/>	<input checked="" type="checkbox"/>	A list of the flood control projects that did not include stormwater treatment and an explanation for each of why it did not (if applicable).	Part III.A.4	
<input type="checkbox"/>	<input checked="" type="checkbox"/>	A monitoring data summary as directed in Section III.C above and in accordance with Rule 62-624.600(2)(c), F.A.C.	Part V.B.3	
<input checked="" type="checkbox"/>	<input type="checkbox"/>	YEAR 1 ONLY: An inventory of all known major outfalls and a map depicting the location of the major outfalls (hard copy or CD-ROM) in accordance with Rule 62-624.600(2)(a), F.A.C.	Part III.A.1	Attachment A
<input type="checkbox"/>	<input checked="" type="checkbox"/>	YEAR 2: A summary review of codes and regulations to reduce the stormwater impact from development.	Part III.A.2	
<input type="checkbox"/>	<input checked="" type="checkbox"/>	Year 3 ONLY: The estimates of pollutant loadings and event mean concentrations for each major outfall or each major watershed in accordance with Rule 62-624.600(2)(b), F.A.C.	Part V.A	
<input type="checkbox"/>	<input checked="" type="checkbox"/>	YEAR 3: Summary of TMDL Monitoring Results (if applicable).	Part VIII.B.2	
<input type="checkbox"/>	<input checked="" type="checkbox"/>	YEAR 3: Bacteria Pollution Control Plan (if applicable).	Part VIII.B.3	
<input type="checkbox"/>	<input checked="" type="checkbox"/>	YEAR 4: A follow-up report on plan implementation of changes to codes and regulations to reduce the stormwater impact from development.	Part III.A.2	
<input type="checkbox"/>	<input checked="" type="checkbox"/>	YEAR 4: A report on any amendments to the applicable legal authority (if applicable).	Part III.A.7.a	
<input type="checkbox"/>	<input checked="" type="checkbox"/>	YEAR 4: Permit re-application information in accordance with Rule 62-624.420(2), F.A.C. <ul style="list-style-type: none"> The monitoring plan (with revisions, if applicable). If the total annual pollutant loadings have not decreased over the past two permit cycles, revisions to the SWMP, as appropriate. 	Part V.B.3 Part V.A.3	
<input type="checkbox"/>	<input checked="" type="checkbox"/>	YEAR 4: TMDL Supplemental SWMP (if applicable).	Part VIII.B.3	

DO NOT SUBMIT ANY OTHER MATERIALS
(such as records and logs of activities, monitoring raw data, public outreach materials, etc.)

SECTION VI. CERTIFICATION STATEMENT AND SIGNATURE

The Responsible Authority listed in Section I.F above must sign the following certification statement, as per Rule 62-620.305, F.A.C.:

I certify under penalty of law that this document and all attachments were prepared under my direction or supervision in accordance with a system designed to assure that qualified personnel properly gathered and evaluated the information submitted. Based upon my inquiry of the person or persons who manage the system, or those persons directly responsible for gathering the information, the information submitted is, to the best of my knowledge and belief, true, accurate and complete. I am aware that there are significant penalties for submitting false information, including the possibility of fine and imprisonment for knowing violations.

Name of Responsible Authority (type or print): Daniel Clark

Title: Town Administrator

Signature:  Date: 1/29/18

SECTION VII. STORMWATER MANAGEMENT PROGRAM (SWMP) SUMMARY TABLE

A.	B.					C.	D.	E.	F.
Permit Citation/ SWMP Element	Permit Requirement/Quantifiable SWMP Activity					Number of Activities Performed	Documentation / Record	Entity Performing the Activity	Comments
Part III.A.1	Structural Controls and Stormwater Collection Systems Operation								
<p>Report the current known inventory.</p> <p>Report the number of inspection and maintenance activities conducted for each applicable type of structure included in Table II.A.1.a, and the percentage of the total inventory of each type of structure inspected and maintained.</p> <p><i>Note: Delete structures that are not in your MS4's inventory. The permittee may choose its own unit of measurement for each structural control to be consistent with the unit of measurement in the documentation. Unit options include: miles, linear feet, acres, etc.</i></p>									
Type of Structure		Number of Structures	Number of Inspections	Percent Inspected	Number of Maintenance Activities	Percent Maintained			
		Dry retention systems	2	2	100	2	100	Tracking Sheet	LCS
Underdrain filter systems		0	N/A	N/A	N/A	N/A	N/A	N/A	
Exfiltration trench / French drains (If)		0	N/A	N/A	N/A	N/A	N/A	N/A	
Grass treatment swales (miles)		0	N/A	N/A	N/A	N/A	N/A	N/A	
Dry detention systems		1	1	100	1	100	Tracking Sheet	LCS	Debris Removal
Wet detention systems		0	N/A	N/A	N/A	N/A	N/A	N/A	
Detention with filtration systems		0	N/A	N/A	N/A	N/A	N/A	N/A	
Alum Injection systems		0	N/A	N/A	N/A	N/A	N/A	N/A	
Pollution control boxes		0	N/A	N/A	N/A	N/A	N/A	N/A	
pump stations		0	N/A	N/A	N/A	N/A	N/A	N/A	
Major outfalls		4	4	100	0	0	Road Main. Sch.	LCS	
Weirs or other control structures		0	N/A	N/A	N/A	N/A	N/A	N/A	
pipes / culverts (miles)		3.53	1(all)	100	0	0	Road Main. Sch.	LCS	
Canals		0	N/A	N/A	N/A	N/A	N/A	N/A	
Inlets / catch basins / grates		156	156	100	1	0.6	Work Order	LCS	
Ditches / conveyance swales (miles)		0	N/A	N/A	N/A	N/A	N/A	N/A	
<p>If the minimum inspection frequencies set forth in Table II.A.1.a. were not met, provide as an attachment an explanation of why they were not and a description of the actions that will be taken to ensure that they will be met.</p>		<input type="checkbox"/>							Minimum frequencies met.

SECTION VII. STORMWATER MANAGEMENT PROGRAM (SWMP) SUMMARY TABLE						
A.	B.	C.	D.	E.	F.	
Permit Citation/ SWMP Element	Permit Requirement/Quantifiable SWMP Activity	Number of Activities Performed	Documentation / Record	Entity Performing the Activity	Comments	
Part III.A.1 Summary	Provide an evaluation of the Stormwater Management Program according to Part VI.B.2 of the permit.					
	Strengths: Inspections and resulting maintenance, if required, have occurred more frequently than required per Table II.A.1.a					
	Limitations: There are no known limitations of the SWMP					
	SWMP revisions implemented to address limitations: N/A					
Part III.A.2	Areas of New Development and Significant Redevelopment					
	Report the number of significant development projects, including new and redevelopment, reviewed and approved by the permittee for post-development stormwater considerations.					
	Number of significant development projects reviewed		0	N/A	N/A	N/A
	Number of significant development projects approved		0	N/A	N/A	N/A
	Provide in the Year 2 Annual Report the summary report of the review activity. Provide in the Year 4 Annual Report the follow-up report on plan implementation.					
	Year 2 ONLY: Attach the summary report of the review activity		<input type="checkbox"/>	N/A	N/A	N/A
	Year 4 ONLY: Attach the follow-up report on plan implementation		<input type="checkbox"/>	N/A	N/A	N/A
Part III.A.2 Summary	Provide an evaluation of the Stormwater Management Program according to Part VI.B.2 of the permit.					
	Strengths: N/A					
	Limitations: N/A					
	SWMP revisions implemented to address limitations: N/A					
Part III.A.3	Roadways					
	Report on the litter control program, including the frequency of litter collection, an estimate of the total number of road miles cleaned or amount of area covered by the activities, and an estimate of the quantity of litter collected. <i>Note: If the permittee does not contract activities, delete CONTRACTOR activities.</i>					
	PERMITTEE Litter Control: Frequency of litter collection		2	Website Resolution	LCS	International Coastal;Keep PBC Beautiful
	PERMITTEE Litter Control: Estimated amount of area maintained (miles)		14.2	Website Resolution	LCS	CAD Map
	PERMITTEE Litter Control: Estimated amount of litter collected (lbs)		2,400	International Report	Coastal Cleanup	
	CONTRACTOR Litter Control: Frequency of litter collection		1/week	Invoices	Bass Landscaping	Parks
	CONTRACTOR Litter Control: Estimated amount of area maintained (miles)		14.2	Invoices	Bass Landscaping	Parks
	CONTRACTOR Litter Control: Estimated amount of litter collected (cy)		114	Invoices	Bass Landscaping	Parks
	OPTIONAL: If an Adopt-A-Road or similar program is implemented, report the total number of road miles cleaned and an estimate of the quantity of litter collected. If you do not participate in an Adopt-A-Road program, report "0".					

SECTION VII. STORMWATER MANAGEMENT PROGRAM (SWMP) SUMMARY TABLE					
A.	B.	C.	D.	E.	F.
Permit Citation/ SWMP Element	Permit Requirement/Quantifiable SWMP Activity	Number of Activities Performed	Documentation / Record	Entity Performing the Activity	Comments
	Trash Pick-up Events: Total miles cleaned	14.2	Website Resolution	Great American Cleanup	Lakes & Canals
	Trash Pick-up Events: Estimated amount of litter collected (cy)	940	American Report	Great American Cleanup	
	Adopt-A-Road: Total miles cleaned	0	0	0	
	Adopt-A-Road: Estimated amount of litter collected (cy)	0	0	0	
	Report on the street sweeping program, including the frequency of the sweeping, total miles swept, an estimate of the quantity of sweepings collected, and the total nitrogen and total phosphorus loadings that were removed by the collection of sweepings. If no street sweeping program is implemented, provide the explanation of why not in column F.				
	Frequency of street sweeping	N/A	N/A	N/A	No curb & gutter
	Total miles swept	N/A	N/A	N/A	N/A
	Estimated quantity of sweeping material collected (cy / tons)	N/A	N/A	N/A	N/A
	Total phosphorous loadings removed (pounds)	N/A	N/A	N/A	N/A
	Total nitrogen loadings removed (pounds)	N/A	N/A	N/A	N/A
	Report the equipment yards and maintenances shops that support road maintenance activities, and the number of inspections conducted for each facility.				
	Name of Facility	Number of Inspections			
N/A	N/A				
Part III.A.3 Summary	Provide an evaluation of the Stormwater Management Program according to Part VI.B.2 of the permit.				
	Strengths: The trash pick up events are effective in providing planned, consistent litter collection.				
	Limitations: There are no known limitations of the SWMP.				
	SWMP revisions implemented to address limitations: N/A				
Part III.A.4	Flood Control Projects				
Report the total number of flood control projects that were constructed by the permittee during the reporting period and the number of those projects that did NOT include stormwater treatment. The permittee shall provide a list of the projects where stormwater treatment was not included with an explanation for each of why it was not.					
Report on any stormwater retrofit planning activities and the associated implementation of retrofitting projects to reduce stormwater pollutant loads from existing drainage systems that do not have treatment BMPs.					
Flood control projects completed during the reporting period		0	N/A	N/A	N/A
Flood control projects completed that did not include stormwater treatment		0	N/A	N/A	N/A
Stormwater retrofit projects planned/under construction		0	N/A	N/A	N/A
Stormwater retrofit projects completed		0	N/A	N/A	N/A
If there were projects that did not include stormwater treatment, provide as an attachment a list of the projects and an explanation for each of why it did not.		<input type="checkbox"/>	N/A	N/A	N/A

SECTION VII. STORMWATER MANAGEMENT PROGRAM (SWMP) SUMMARY TABLE					
A.	B.	C.	D.	E.	F.
Permit Citation/ SWMP Element	Permit Requirement/Quantifiable SWMP Activity	Number of Activities Performed	Documentation / Record	Entity Performing the Activity	Comments
Part III.A.4 Summary	Provide an evaluation of the Stormwater Management Program according to Part VI.B.2 of the permit.				
	Strengths: N/A				
	Limitations: N/A				
	SWMP revisions implemented to address limitations: N/A				
Part III.A.5	Municipal Waste Treatment, Storage, and Disposal Facilities Not Covered by an NPDES Stormwater Permit				
	Report the applicable facilities and the number of the inspections conducted for each facility.				
	Name of Facility	Number of Inspections			
	None	N/A	N/A	N/A	N/A
Part III.A.5 Summary	Provide an evaluation of the Stormwater Management Program according to Part VI.B.2 of the permit.				
	Strengths: N/A				
	Limitations: N/A				
	SWMP revisions implemented to address limitations: N/A				
Part III.A.6	Pesticides, Herbicides, and Fertilizer Application				
	Report the number of permittee personnel applicators and contracted commercial applicators of pesticides and herbicides who are FDACS certified / licensed.				
	Report the number of permittee personnel who have been trained through the Green Industry BMP Program and the number of contracted commercial applicators of fertilizer who are FDACS certified / licensed.				
	PERSONNEL: FDACS public applicators of pesticides/herbicides	0	N/A	N/A	No personnel apply pesticides
	CONTRACTORS: FDACS commercial applicators of pesticides/ herbicides	3	PHF Licenses	FDACS	Bass Aquatic Weed Control Safe Home Pest Control
	PERSONNEL: Green Industry BMP Program training completed	2	Licenses	LCS	Robert, Brian
	CONTRACTORS: FDACS certified / licensed applicators of fertilizer	5	Licenses	LCS	Damon, Eddie, Kyle, Robert, Brian
	Provide a copy of the adopted ordinance with the Year 2 Annual Report. If this provision is not applicable because the permittee is not within the watershed of a nutrient-impaired water body, indicate that in Column F.				
Year 2 ONLY: Attach copy of adopted Florida-friendly ordinance	<input type="checkbox"/>			N/A	
Report on the public education and outreach activities that are performed or sponsored by the permittee within the permittee's jurisdiction to encourage citizens to reduce their use of pesticides, herbicides and fertilizers including the type and number of activities conducted, the type and number of materials distributed, and the number of Web site visits (if applicable).					

SECTION VII. STORMWATER MANAGEMENT PROGRAM (SWMP) SUMMARY TABLE					
A.	B.	C.	D.	E.	F.
Permit Citation/ SWMP Element	Permit Requirement/Quantifiable SWMP Activity	Number of Activities Performed	Documentation / Record	Entity Performing the Activity	Comments
	Public Education and Outreach Program	The public outreach and education plan is carried out as a joint effort by the Palm Beach County Co-permittees. Please see the Palm Beach County Joint Annual Report for the public education and outreach information.			
	Brochures/Flyers/Fact sheets distributed	100+	Proof of Purchase	LCS	Storm Drain Labels
	Neighborhood presentations: Number conducted	0	N/A	N/A	N/A
	Neighborhood presentations: Number of participants	0	N/A	N/A	N/A
	Newspapers & newsletters: Number of articles/notices published	0	N/A	N/A	N/A
	Newsletters: Number of newsletters distributed	0	N/A	N/A	N/A
	Public displays (e.g., kiosks, storyboards, posters, etc.)	1	N/A	LCS	Annual BBQ Information Stand
	Radio or television Public Service Announcements (PSAs)	0	N/A	N/A	N/A
	School presentations: Number conducted	0	N/A	N/A	N/A
	School presentations: Number of participants	0	N/A	N/A	N/A
	Seminars/Workshops: Number conducted	0	N/A	N/A	N/A
	Seminars/Workshops: Number of participants	0	N/A	N/A	N/A
	Special events: Number conducted	0	N/A	N/A	N/A
Special events: Number of participants	0	N/A	N/A	N/A	
	Number of visitors to stormwater-related pages	27	Google Analytics	LCS	N/A
Part III.A.6 Summary	Provide an evaluation of the Stormwater Management Program according to Part VI.B.2 of the permit.				
	Strengths: The public outreach activities are conducted in a consistent manner.				
	Limitations: There are no known limitations of the SWMP.				
	SWMP revisions implemented to address limitations: N/A				
Part III.A.7.a	Illicit Discharges and Improper Disposal — Inspections, Ordinances, and Enforcement Measures				
	Report amendments in Year 4.				
	Year 4 ONLY: Attach a report on amendments to applicable legal authority	<input type="checkbox"/>			N/A
Part III.A.7.c	Illicit Discharges and Improper Disposal — Investigation of Suspected Illicit Discharges and/or Improper Disposal				
	Report on the proactive inspection program, including the number of inspections conducted by the permittee, the number of illicit activities found, and the number and type of enforcement actions taken.				
	Proactive inspections for suspected illicit discharges	1	Tracking Sheet	LCS	Whole Town Drainage Systems Waterways
	Illicit discharges found during a proactive inspection	0	Illicit Discharge Log	LCS	

SECTION VII. STORMWATER MANAGEMENT PROGRAM (SWMP) SUMMARY TABLE					
A.	B.	C.	D.	E.	F.
Permit Citation/ SWMP Element	Permit Requirement/Quantifiable SWMP Activity	Number of Activities Performed	Documentation / Record	Entity Performing the Activity	Comments
	NOV/WL/citation/fines issued for illicit discharges found during proactive inspection	0	Illicit Discharge Log	LCS	
	Report on the reactive investigation program as it relates to responding to reports of suspected illicit discharges, including the number of reports received, the number of investigations conducted, the number of illicit activities found, and the number and type of enforcement actions taken.				
	Reports of suspected illicit discharges received	0	Illicit Discharge Log	LCS	
	Reactive investigations of reports of suspected illicit discharges etc.	0	Illicit Discharge Log	LCS	
	Illicit discharges etc. found during reactive investigation	0	Illicit Discharge Log	LCS	
	NOV/WL/citation/fines issued for illicit discharges etc. found during reactive investigation	0	N/A	LCS	
	Report the type of training activities, and the number of permittee personnel and contractors trained (both in-house and outside training) within the reporting year.				
	Personnel trained	3	Sign-In Sheets	NPDES Group	Robert, Brian, Jay
	Contractors trained	0	N/A		
Part III.A.7.d	Illicit Discharges and Improper Disposal — Spill Prevention and Response				
	Report on the spill prevention and response activities, including the number of spills addressed.				
	Hazardous and non-hazardous material spills responded to	0	PBC	PBC	
	Report the type of training activities, and the number of permittee personnel and contractors trained (both in-house and outside training) within the reporting year.				
	Personnel trained	3	Sign-In Sheet	NPDES Group	Robert, Brian, Jay
	Contractors trained	0	N/A		
Part III.A.7.e	Illicit Discharges and Improper Disposal — Public Reporting				
	Report on the public education and outreach activities that are performed or sponsored by the permittee within the permittee's jurisdiction to encourage the public reporting of suspected illicit discharges and improper disposal of materials, including the type and number of activities conducted, the type and number of materials distributed, and the number of Web site visits (if applicable).				
	Public Education and Outreach Program	The public outreach and education plan is carried out as a joint effort by the Palm Beach County Co-permittees. Please see the Palm Beach County Joint Annual Report for the public education and outreach information.			
	Brochures/Flyers/Fact sheets distributed	100+	Proof of Purchase	LCS	Storm Drain Labels
	Neighborhood presentations: Number conducted	0	N/A	N/A	N/A
	Neighborhood presentations: Number of participants	0	N/A	N/A	N/A
	Newspapers & newsletters: Number of articles/notices published	0	N/A	N/A	N/A
	Newsletters: Number of newsletters distributed	0	N/A	N/A	N/A

SECTION VII. STORMWATER MANAGEMENT PROGRAM (SWMP) SUMMARY TABLE					
A.	B.	C.	D.	E.	F.
Permit Citation/ SWMP Element	Permit Requirement/Quantifiable SWMP Activity	Number of Activities Performed	Documentation / Record	Entity Performing the Activity	Comments
	Public displays (e.g., kiosks, storyboards, posters, etc.)	1	N/A	LCS	Annual BBQ Information Stand
	Radio or television Public Service Announcements (PSAs)	0	N/A	N/A	N/A
	School presentations: Number conducted	0	N/A	N/A	N/A
	School presentations: Number of participants	0	N/A	N/A	N/A
	Seminars/Workshops: Number conducted	0	N/A	N/A	N/A
	Seminars/Workshops: Number of participants	0	N/A	N/A	N/A
	Special events: Number conducted	0	N/A	N/A	N/A
	Special events: Number of participants	0	N/A	N/A	N/A
	Number of visitors to stormwater-related pages	27	Google Analytics	LCS	N/A
Part III.A.7.f	Illicit Discharges and Improper Disposal — Oils, Toxics, and Household Hazardous Waste Control				
	Report on the public education and outreach activities that are performed or sponsored by the permittee within the permittee's jurisdiction to encourage the proper use and disposal of oils, toxics, and household hazardous waste, including the type and number of activities conducted, the type and number of materials distributed, the amount of waste collected / recycled / properly disposed, and the number of Web site visits (if applicable).				
	Public Education and Outreach Program	The public outreach and education plan is carried out as a joint effort by the Palm Beach County Co-permittees. Please see the Palm Beach County Joint Annual Report for the public education and outreach information.			
	Brochures/Flyers/Fact sheets distributed	100+	Proof of Purchase	LCS	Storm Drain Labels
	Neighborhood presentations: Number conducted	0	N/A	N/A	N/A
	Neighborhood presentations: Number of participants	0	N/A	N/A	N/A
	Newspapers & newsletters: Number of articles/notices published	0	N/A	N/A	N/A
	Newsletters: Number of newsletters distributed	0	N/A	N/A	N/A
	Public displays (e.g., kiosks, storyboards, posters, etc.)	1	N/A	LCS	Annual BBQ Information Stand
	Radio or television Public Service Announcements (PSAs)	0	N/A	N/A	N/A
	School presentations: Number conducted	0	N/A	N/A	N/A
	School presentations: Number of participants	0	N/A	N/A	N/A
	Seminars/Workshops: Number conducted	0	N/A	N/A	N/A
	Seminars/Workshops: Number of participants	0	N/A	N/A	N/A
	Special events: Number conducted	0	N/A	N/A	N/A
	Special events: Number of participants	0	N/A	N/A	N/A
	Storm sewer inlets newly marked/replaced	0	N/A	N/A	N/A
	Number of visitors to stormwater-related pages	27	Google Analytics	LCS	N/A

SECTION VII. STORMWATER MANAGEMENT PROGRAM (SWMP) SUMMARY TABLE							
A.	B.			C.	D.	E.	F.
Permit Citation/ SWMP Element	Permit Requirement/Quantifiable SWMP Activity			Number of Activities Performed	Documentation / Record	Entity Performing the Activity	Comments
Part III.A.7.g	Illicit Discharges and Improper Disposal — Limitation of Sanitary Sewer Seepage						
	Report on the type and number of activities undertaken to reduce or eliminate SSOs and inflow/ infiltration, the number of SSOs or inflow / infiltration incidents found and the number resolved, and the name of the owner of the sanitary sewer system within the permittee's jurisdiction. Report only the SSOs and inflow / infiltration incidents into the MS4.						
	Owner of the sanitary sewer system			Homeowner Septic Tanks, some PBCWUD, LCS Gravity, 3LS & FM			
	Activity to reduce/eliminate SSOs and I&I: (description)			N/A	N/A	N/A	Gravity and LS are new systems
	Activity to reduce/eliminate SSOs and I&I: (description)			N/A	N/A	N/A	N/A
	SSO incidents discovered			0	N/A	N/A	N/A
	SSO incidents resolved			N/A	N/A	N/A	N/A
	Inflow / infiltration incidents discovered			0	0	0	0
	Inflow / infiltration incidents resolved			N/A	N/A	N/A	N/A
Part III.A.7 Summary	For activities required by Part III.A.7: Provide an evaluation of the Stormwater Management Program according to Part VI.B.2 of the permit.						
	Strengths: N/A						
	Limitations: N/A						
	SWMP Revisions implemented to address limitations: N/A						
Part III.A.8.a	Industrial and High-Risk Runoff — Identification of Priorities and Procedures for Inspections						
	Report on the high-risk facilities inventory, including the type and total number of high risk facilities and the number of facilities newly added each year. Report on the high-risk facilities inspection program, including the number of inspections conducted and the number and type of enforcement actions taken.						
	Type of Facility	Number of Facilities	Number of Inspections	Enforcement Actions			
	Operating municipal landfills	0	N/A	N/A	N/A	N/A	N/A
	Hazardous waste treatment, storage, disposal and recovery (HWTSDR) facilities	0	N/A	N/A	N/A	N/A	N/A
	EPCRA Title III, Section 313 facilities (TRI)	0	N/A	N/A	N/A	N/A	N/A
	Facilities determined as high risk by the permittee	0	N/A	N/A	N/A	N/A	N/A
Part III.A.8.b	Industrial and High-Risk Runoff — Monitoring for High Risk Industries						
	Report the number of high risk facilities sampled.						
	High risk facilities sampled		N/A	N/A	N/A	N/A	N/A

SECTION VII. STORMWATER MANAGEMENT PROGRAM (SWMP) SUMMARY TABLE					
A.	B.	C.	D.	E.	F.
Permit Citation/ SWMP Element	Permit Requirement/Quantifiable SWMP Activity	Number of Activities Performed	Documentation / Record	Entity Performing the Activity	Comments
Part III.A.8 Summary	Provide an evaluation of the Stormwater Management Program according to Part VI.B.2 of the permit.				
	Strengths: N/A				
	Limitations: N/A				
	SWMP revisions implemented to address limitations: N/A				
Part III.A.9.a	Construction Site Runoff — Site Planning and Non-Structural and Structural Best Management Practices				
	Report the number of permittee and private pre-construction site plans reviewed for stormwater, erosion, and sedimentation controls, and the number approved.				
	PERMITTEE SITES: Construction site plans reviewed	0	N/A	LCS	LCS Built Out
	PERMITTEE SITES: Construction site plans approved	0	N/A	LCS	LCS Built Out
	PRIVATE SITES: Construction site plans reviewed	0	N/A	LCS	LCS Built Out
	PRIVATE SITES: Construction site plans approved	0	N/A	LCS	LCS Built Out
	Report the number of development permit applicants notified of the ERP and CGP, and the number of applicants who confirmed ERP and CGP coverage.				
	Notified of ERP stormwater permit requirements	0	N/A	LCS	Codes & Ordinances 86-862,88-88.20-C
	Confirmed ERP coverage	0	N/A	LCS	
	Notified of CGP stormwater permit requirements	0	N/A	LCS	Codes & Ordinances 86-862,88-88.20-C
	Confirmed CGP coverage	0	N/A	LCS	
Part III.A.9.b	Construction Site Runoff — Inspection and Enforcement				
	Report on the inspection program for privately-operated and permittee-operated construction sites, including the number of active construction sites during the reporting year, the number of inspections of active construction sites, the percentage of active construction sites inspected, and the number and type of enforcement actions / referrals taken.				
	PERMITTEE SITES: Active construction sites	0	N/A	LCS	
	PERMITTEE SITES: Pre-, During, and Post inspections of active construction sites for E&S and waste control BMPs	0	N/A	LCS	
	PERMITTEE SITES: Percentage of active construction sites inspected	0	N/A	LCS	
	PRIVATE SITES: Active construction sites	0	N/A	LCS	
	PRIVATE SITES: Pre-, During, and Post inspections of active construction sites for E&S and waste control BMPs	0	N/A	LCS	
	PRIVATE SITES: Percentage of active construction sites inspected	0	N/A	LCS	
	Enforcement Action	0	N/A	LCS	
Part III.A.9.c	Construction Site Runoff — Site Operator Training				
	Report the type of training activities, the number of inspectors, site plan reviewers and site operators trained (both in-house and outside training).				
		DEP Certification	Annual Training		

SECTION VII. STORMWATER MANAGEMENT PROGRAM (SWMP) SUMMARY TABLE						
A.	B.		C.	D.	E.	F.
Permit Citation/ SWMP Element	Permit Requirement/Quantifiable SWMP Activity		Number of Activities Performed	Documentation / Record	Entity Performing the Activity	Comments
	Permittee construction site inspectors	1	1	Certificates	NPDES Group	Robert
	Permittee construction site plan reviewers		0	N/A	N/A	
	Permittee construction site operators		0	N/A	N/A	
Part III.A.9 Summary	Provide an evaluation of the Stormwater Management Program according to Part VI.B.2 of the permit.					
	Strengths: Training has been obtained on a consistent basis.					
	Limitations: There are no known limitations of the SWMP.					
	SWMP revisions implemented to address limitations: N/A					

SECTION VIII. CHANGES TO THE STORMWATER MANAGEMENT PROGRAM (SWMP) ACTIVITIES (Not Applicable in Year 4)		
A.	Permit Citation/ SWMP Element	Proposed Changes to the Stormwater Management Program Activities Established as Specific Requirements Under Part III.A of the Permit (Including the Rationale for the Change) — REQUIRES DEP APPROVAL PRIOR TO CHANGE IF PROPOSING TO REPLACE OR DELETE AN ACTIVITY.
		N/A
B.	Permit Citation/ SWMP Element	Changes to the Stormwater Management Program Activities NOT Established as Specific Requirements Under Part III.A of the Permit (Including the Rationale for the Change)
		N/A

SECTION IX. TMDL Status Report

A.	YEAR 1 Provide a table summarizing the status of the TMDL process. Include a list of prioritized TMDLs and their monitoring and implementation schedule; and include the Identification number of the outfall prioritized for TMDL monitoring.								
	WBID Number	Segment/ Waterbody/ Basin	Pollutant of Concern	TMDL DEP / EPA	Percent Reduction (WLA)	Priority Rank	Priority Outfall	Monitoring Summary / BPCP Due Date	Supplemental SWMP Due Date
	N/A			<input type="checkbox"/> / <input type="checkbox"/>		1		(Year 3 AR)	(Year 4 AR; N/A) if BPCP)
				<input type="checkbox"/> / <input type="checkbox"/>					
B.	YEAR 3 and annually thereafter, provide a summary of the estimated load reductions that have occurred for the pollutant(s) of concern being discharged from the MS4 to the TMDL water body during the reporting period and cumulatively since the date the Supplemental SWMP was implemented. Year 3: Submit a Monitoring data summary or BPCP (if applicable). Year 4: Submit a Supplemental SWMP (if applicable).								
	WBID Number	Pollutant of Concern	Monitoring Summary / BPCP Submitted	Supplemental SWMP Submitted	Projected load reductions OR Actual load reductions to date				
	N/A		(Year 3 AR)	(Year 4 AR; N/A if BPCP)					
C.	Provide a brief statement as to the status of TMDL implementation according to Part VIII.B of the permit (e.g. status of monitoring to validate WLA): No discharge to a TMDL WBID at the time of permit issuance.								

Attachment A

Inventory of Outfalls

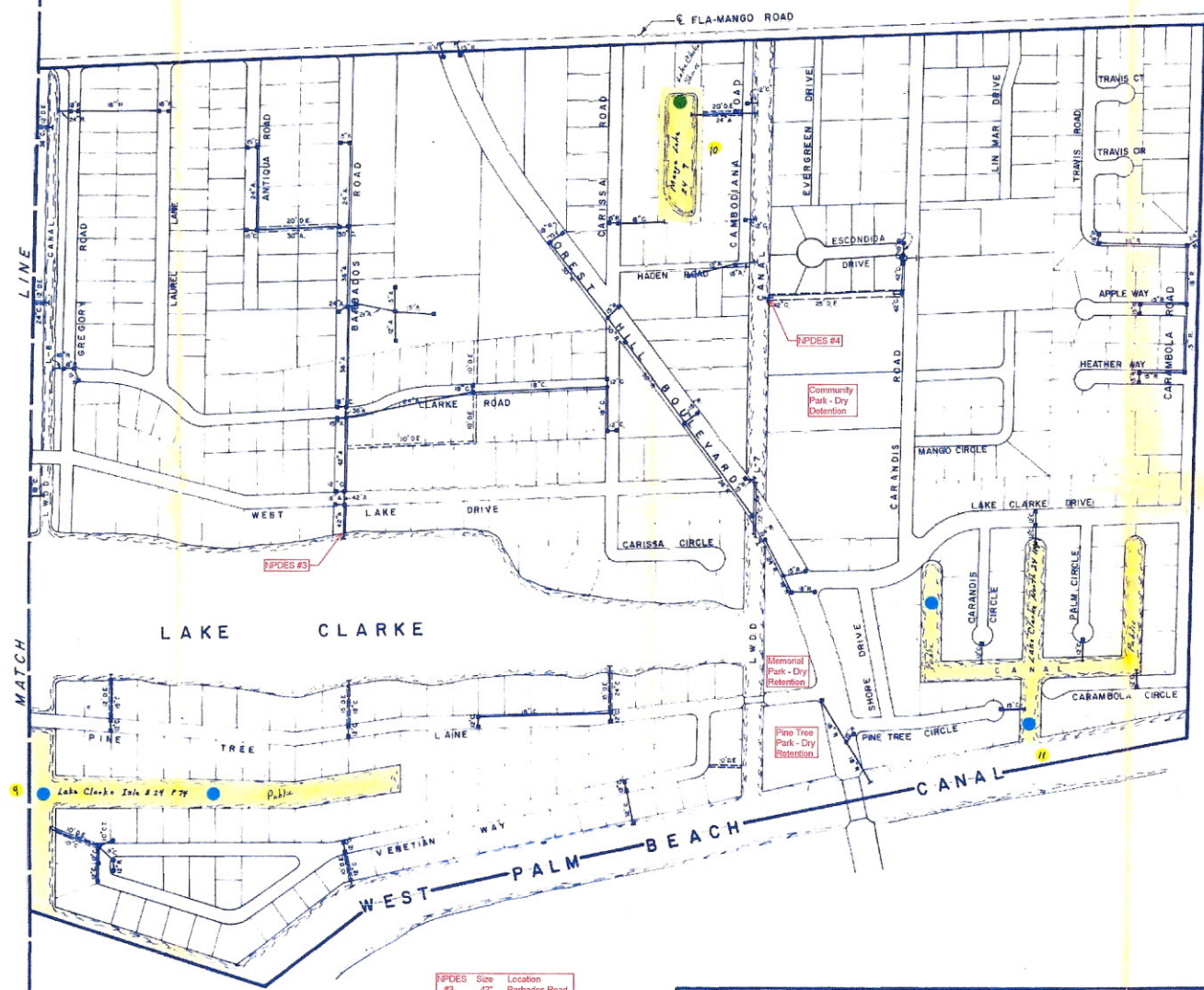

MATCH LINE

LAKE CLARKE

NPDES	Size	Location
#3	42"	Barbados Road
#4	42"	Carandis Road

NPDES - ID Map
 NPDES Modifications added by
 SJE - 2/7/12



BASE MAP PREPARED BY:
 BARKER, OSHA & ANDERSON, INC.



<table border="1"> <tr> <td>● Lake Clarke Shores</td> <td>FIELD BOOK NO.</td> <td>PS</td> <td>90-1026</td> </tr> <tr> <td>● Public</td> <td>DESIGN</td> <td>RLM</td> <td>N.T.S.</td> </tr> <tr> <td>● Private</td> <td>DRAWN</td> <td>RLM</td> <td>2</td> </tr> <tr> <td>DATE</td> <td>DESCRIPTION</td> <td>BY</td> <td>CHECKED</td> </tr> <tr> <td colspan="2">REVISIONS</td> <td>APPROVED</td> <td>DATE</td> </tr> </table>	● Lake Clarke Shores	FIELD BOOK NO.	PS	90-1026	● Public	DESIGN	RLM	N.T.S.	● Private	DRAWN	RLM	2	DATE	DESCRIPTION	BY	CHECKED	REVISIONS		APPROVED	DATE		EXISTING DRAINAGE FACILITIES	Job No.
	● Lake Clarke Shores	FIELD BOOK NO.	PS	90-1026																			
● Public	DESIGN	RLM	N.T.S.																				
● Private	DRAWN	RLM	2																				
DATE	DESCRIPTION	BY	CHECKED																				
REVISIONS		APPROVED	DATE																				
TOWN OF	LAKE CLARKE SHORES	FLORIDA	Scale																				
			Sheet of 2																				
			File No. D-5007-020																				

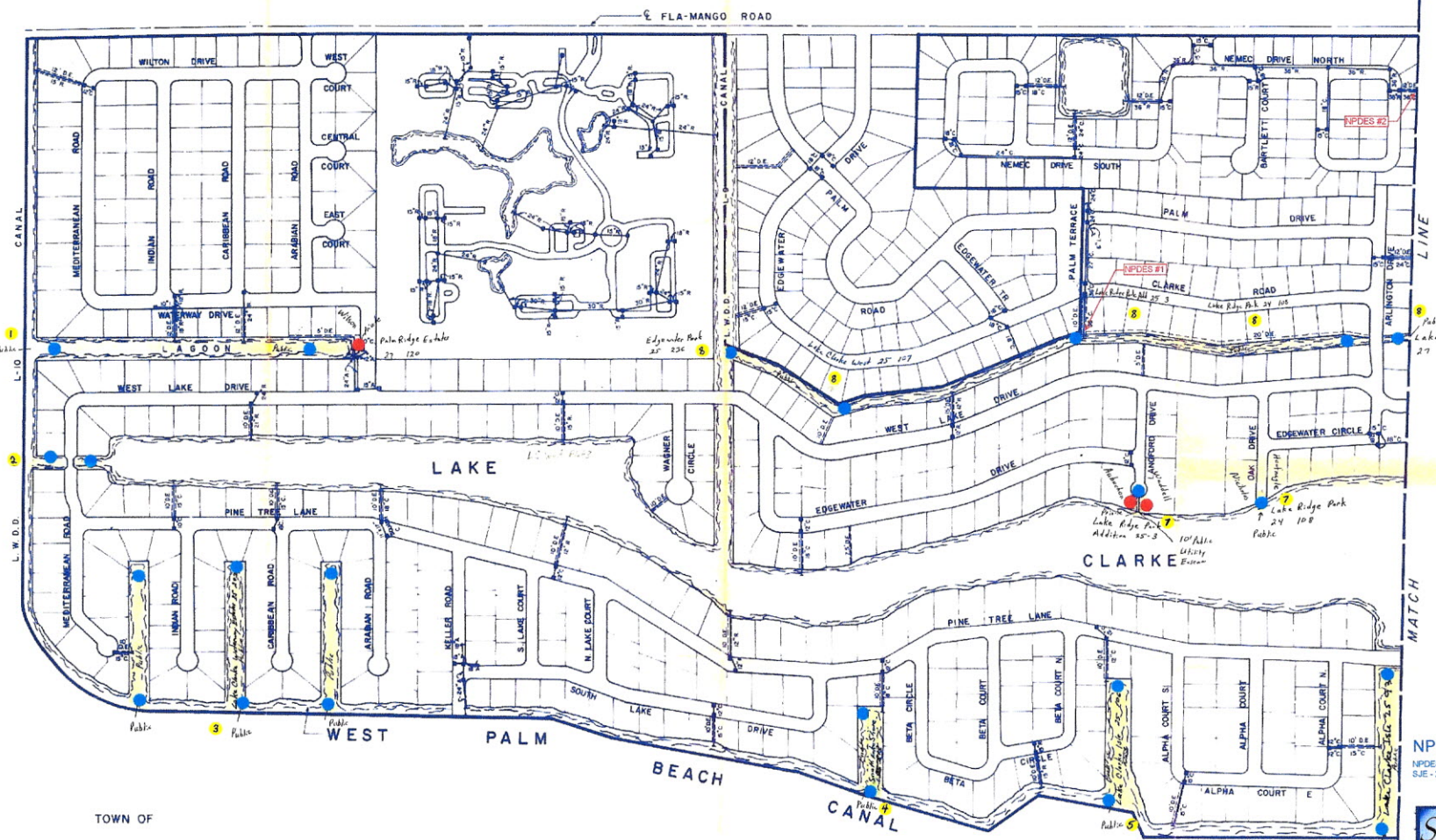

TOWN OF
LAKE CLARKE SHORES



NPDES	Size	Location
#1	30"	Palm Terrace
#2	30"	Nemes Drive North

NPDES - ID Map
NPDES Modifications added by
SJE - 2/7/12



BASE MAP PREPARED BY:
BARKER, OSHA & ANDERSON, INC.

BARKER, OSHA & ANDERSON, INC.
PROFESSIONAL ENGINEERS
NORTH PALM BEACH, FLORIDA

DATE	DESCRIPTION	BY	CHECKED	APPROVED	DATE	EXISTING DRAINAGE FACILITIES	Job No.	Scale
					JULY 1990	TOWN OF LAKE CLARKE SHORES FLORIDA	90-1026	N.T.S.
							Sheet of 2	
							File No.	D-6007-020

**Shalloway, Foy,
Rayman & Newell, Inc.**
ENGINEERS - PLANNERS - SURVEYORS
1710 W. PALM BLVD., SUITE 200
WEST PALM BEACH, FLORIDA 33411
TEL: 561-833-4444