



Annual Report Form For Individual NPDES Permits For Municipal Separate Storm Sewer Systems (RULE 62-624.600(2), F.A.C.)

- This Annual Report Form must be completed and submitted to the Department to satisfy the annual reporting requirements established in Rule 62-621.600, F.A.C.
- Submit this fully completed and signed form and any REQUIRED attachments by email to the NPDES Stormwater Program Administrator or to the MS4 coordinator (<http://www.dep.state.fl.us/water/stormwater/npdes/contacts.htm>). Files larger than 10MB may be placed on the FTP site at: ftp://ftp.dep.state.fl.us/pub/NPDES_Stormwater/. After uploading files, email the MS4 coordinator or NPDES Program Administrator to notify them the report is ready for downloading; or by mail to the address in the box at right.
- Refer to the Form Instructions for guidance on completing each section.
- **Please print or type information in the appropriate areas below.**

Submit the form and attachments to:
 Florida Department of Environmental Protection
 Mail Station 3585
 2600 Blair Stone Road
 Tallahassee, Florida 32399-2400

SECTION I. BACKGROUND INFORMATION	
A.	Permittee Name: Town of Palm Beach Shores
B.	Permit Name: Palm Beach County MS4
C.	Permit Number: FLS000018-004
D.	Annual Report Year: <input checked="" type="checkbox"/> Year 1 <input type="checkbox"/> Year 2 <input type="checkbox"/> Year 3 <input type="checkbox"/> Year 4 <input type="checkbox"/> Year 5 <input type="checkbox"/> Other, specify Year:
E.	Reporting Time Period (month/year): 10/ 2016 through 9 / 2017
F.	Name of the Responsible Authority: Alan Welch
	Title: Public Works Director
	Mailing Address: 247 Edwards Lane
	City: Palm Beach Shores Zip Code: 33404 County: Palm Beach County
	Telephone Number: 561-844-3457 Fax Number: 561-863-1350
	E-mail Address: awelch@pbstownhall.org
G.	Name of the Designated Stormwater Management Program Contact (if different from Section I.F above): Alan Welch
	Title: Public Works Director
	Department: Public Works
	Mailing Address: 247 Edwards Lane
	City: Palm Beach Shores Zip Code: 33404 County: Palm Beach County
	Telephone Number: 561-844-3457 Fax Number: 561-863-1350
	E-mail Address: awelch@pbstownhall.org

SECTION II. MS4 MAJOR OUTFALL INVENTORY (Not Applicable in Year 1)	
A.	Number of outfalls ADDED to the outfall inventory in the current reporting year (insert "0" if none): 0 (Does this number include non-major outfalls? <input type="checkbox"/> Yes <input type="checkbox"/> No <input checked="" type="checkbox"/> Not Applicable)
B.	Number of outfalls REMOVED from the outfall inventory in the current reporting year (insert "0" if none): 0 (Does this number include non-major outfalls? <input type="checkbox"/> Yes <input type="checkbox"/> No <input checked="" type="checkbox"/> Not Applicable)
C.	Is the change in the total number of outfalls due to lands annexed or vacated? <input type="checkbox"/> Yes <input type="checkbox"/> No <input checked="" type="checkbox"/> Not Applicable

SECTION III. PART V.B. ASSESSMENT PROGRAM

A.	<p>Provide a brief statement as to the status of water quality monitoring plan implementation. Status may include sampling frequency changes, monitoring location changes, or sampling waiver conditions. <i>DEP Note: If permittee participates in a collaborative monitoring plan, permittee may refer to a joint response as defined by the interlocal agreement.</i></p> <p>Name and date of the approved plan: Current approved plan for the Group Monitoring Plan is September 8, 2016 (with issuance of the Cycle 4 permit). Our newly developed, individual Assessment Plan was submitted on September 8, 2017.</p> <p>Status: The Group Monitoring Report is included in the Cycle 4, Year 1 Joint Annual Report. The new-developed, individual Assessment Plan is awaiting approval by FDEP.</p>
B.	<p>Provide a brief discussion of the monitoring and loading results to date which includes a summary of the water quality monitoring data and / or stormwater pollutant loading changes from the reporting year. <i>DEP Note: Results must be specific to the permittee's SWMP.</i></p> <p>Please refer to the Cycle 4, Year 1 Joint Annual Report for a summary of the Group's water quality monitoring results for the reporting period. Refer to the Cycle 3, Year 6 Joint Annual Report for proposed pollutant loading analysis changes. The best available information on existing pollutant loading estimates is documented in the Cycle 3, Year 3 Joint Annual Report.</p> <p>The newly-development individual Assessment Plan is under review by FDEP and will be implemented during Year 2 of the permit cycle. Note that in any future reporting year, the Group's water quality monitoring data for the reporting period may be available for 4 to 6 months after the reporting period has ended. Consequently, any water quality data from the Group's Program that is used as part of an individual permittee's Assessment Plan for the report period, will be based on the previous year's data.</p>
C.	<p>Attach a monitoring data summary as required by the permit. An analysis of the data discussing changes in water quality and/or stormwater pollutant loading from previous reporting years. <i>DEP Note: Analysis must be specific to the permittee's SWMP.</i></p> <p>See response for Section III.B, above.</p>

SECTION IV. FISCAL ANALYSIS

A.	Total expenditures for the NPDES stormwater management program for the current reporting year: \$8,358.52
B.	Total budget for the NPDES stormwater management program for the subsequent reporting year: \$53,025.00
C.	<p>Did the current reporting year resources decrease from the previous year? Y <input type="checkbox"/> / N <input checked="" type="checkbox"/></p> <p>If program resources decreased, provide a discussion of the impacts on the implementation of the SWMP.</p>

SECTION V. MATERIALS TO BE SUBMITTED WITH THIS ANNUAL REPORT FORM

Only the following materials are to be submitted to the Department along with this fully completed and signed Annual Report Form (check the appropriate box to indicate whether the item is attached or is not applicable):

Attached	N/A	Required Attachments	Permit Citation	Attachment Number/Title
<input type="checkbox"/>	<input checked="" type="checkbox"/>	Any additional information required to be submitted in this current annual reporting year in accordance with Part III.A of your permit that is not otherwise included in Section VII below.	Part III.A	
<input type="checkbox"/>	<input checked="" type="checkbox"/>	An explanation of why the minimum inspection frequency in Table II.A.1.a. was not met, if applicable.	Part II.A.1	
<input type="checkbox"/>	<input checked="" type="checkbox"/>	A list of the flood control projects that did not include stormwater treatment and an explanation for each of why it did not (if applicable).	Part III.A.4	
<input checked="" type="checkbox"/>	<input type="checkbox"/>	A monitoring data summary as directed in Section III.C above and in accordance with Rule 62-624.600(2)(c), F.A.C.	Part V.B.3	Refer to Joint Report
<input checked="" type="checkbox"/>	<input type="checkbox"/>	YEAR 1 ONLY: An inventory of all known major outfalls and a map depicting the location of the major outfalls (hard copy or CD-ROM) in accordance with Rule 62-624.600(2)(a), F.A.C.	Part III.A.1	Stormwater Mpa
<input type="checkbox"/>	<input checked="" type="checkbox"/>	YEAR 2: A summary review of codes and regulations to reduce the stormwater impact from development.	Part III.A.2	
<input type="checkbox"/>	<input checked="" type="checkbox"/>	Year 3 ONLY: The estimates of pollutant loadings and event mean concentrations for each major outfall or each major watershed in accordance with Rule 62-624.600(2)(b), F.A.C.	Part V.A	
<input type="checkbox"/>	<input checked="" type="checkbox"/>	YEAR 3: Summary of TMDL Monitoring Results (if applicable).	Part VIII.B.2	
<input type="checkbox"/>	<input checked="" type="checkbox"/>	YEAR 3: Bacteria Pollution Control Plan (if applicable).	Part VIII.B.3	
<input type="checkbox"/>	<input checked="" type="checkbox"/>	YEAR 4: A follow-up report on plan implementation of changes to codes and regulations to reduce the stormwater impact from development.	Part III.A.2	
<input type="checkbox"/>	<input checked="" type="checkbox"/>	YEAR 4: A report on any amendments to the applicable legal authority (if applicable).	Part III.A.7.a	
<input type="checkbox"/>	<input checked="" type="checkbox"/>	YEAR 4: Permit re-application information in accordance with Rule 62-624.420(2), F.A.C. <ul style="list-style-type: none"> The monitoring plan (with revisions, if applicable). If the total annual pollutant loadings have not decreased over the past two permit cycles, revisions to the SWMP, as appropriate. 	Part V.B.3 Part V.A.3	
<input type="checkbox"/>	<input checked="" type="checkbox"/>	YEAR 4: TMDL Supplemental SWMP (if applicable).	Part VIII.B.3	

DO NOT SUBMIT ANY OTHER MATERIALS
(such as records and logs of activities, monitoring raw data, public outreach materials, etc.)

SECTION VI. CERTIFICATION STATEMENT AND SIGNATURE

The Responsible Authority listed in Section I.F above must sign the following certification statement, as per Rule 62-620.305, F.A.C.:

I certify under penalty of law that this document and all attachments were prepared under my direction or supervision in accordance with a system designed to assure that qualified personnel properly gathered and evaluated the information submitted. Based upon my inquiry of the person or persons who manage the system, or those persons directly responsible for gathering the information, the information submitted is, to the best of my knowledge and belief, true, accurate and complete. I am aware that there are significant penalties for submitting false information, including the possibility of fine and imprisonment for knowing violations.

Name of Responsible Authority (type or print): Alan Welch

Title: Public Works Director

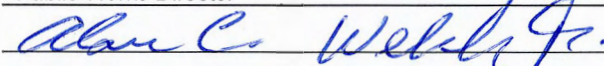
Signature:  Date: 4 / 2 / 18

SECTION VII. STORMWATER MANAGEMENT PROGRAM (SWMP) SUMMARY TABLE

A.	B.					C.	D.	E.	F.
Permit Citation/ SWMP Element	Permit Requirement/Quantifiable SWMP Activity					Number of Activities Performed	Documentation / Record	Entity Performing the Activity	Comments
Part III.A.1	Structural Controls and Stormwater Collection Systems Operation								
Report the current known inventory.									
Report the number of inspection and maintenance activities conducted for each applicable type of structure included in Table II.A.1.a, and the percentage of the total inventory of each type of structure inspected and maintained.									
<i>Note: Delete structures that are not in your MS4's inventory. The permittee may choose its own unit of measurement for each structural control to be consistent with the unit of measurement in the documentation. Unit options include: miles, linear feet, acres, etc.</i>									
Type of Structure		Number of Structures	Number of Inspections	Percent Inspected	Number of Maintenance Activities	Percent Maintained			
Dry retention systems		0	N/A	N/A	N/A	N/A	N/A	N/A	N/A
Underdrain filter systems		0	N/A	N/A	N/A	N/A	N/A	N/A	N/A
Exfiltration trench / French drains (lf)		4	12	100	12	100	Maintenance Logs	Public Works	Inspect & Clean 4 times Annually
Grass treatment swales (miles)		0	N/A	N/A	N/A	N/A	N/A	N/A	N/A
Dry detention systems		0	N/A	N/A	N/A	N/A	N/A	N/A	N/A
Wet detention systems		0	N/A	N/A	N/A	N/A	N/A	N/A	N/A
Detention with filtration systems		0	N/A	N/A	N/A	N/A	N/A	N/A	N/A
Alum Injection systems		0	N/A	N/A	N/A	N/A	N/A	N/A	N/A
Pollution control boxes		0	N/A	N/A	N/A	N/A	N/A	N/A	N/A
pump stations		0	N/A	N/A	N/A	N/A	N/A	N/A	N/A
Major outfalls		6	12	100	0	N/A	Inspection Form	Public Works	N/A
Weirs or other control structures		0	N/A	N/A	N/A	N/A	N/A	N/A	N/A
pipes / culverts (miles)		1.5	2	100	0	0	Inspection Form	Public Works	N/A
Canals		0	N/A	N/A	N/A	N/A	N/A	N/A	N/A
Inlets / catch basins / grates		106	106	50	106	100	Inspection Form	Public Works	N/A
Ditches / conveyance swales (miles)		0	N/A	N/A	N/A	N/A	N/A	N/A	N/A
If the minimum inspection frequencies set forth in Table II.A.1.a. were not met, provide as an attachment an explanation of why they were not and a description of the actions that will be taken to ensure that they will be met.		N/A				N/A	N/A	Minimum Requirements Are Achieved.	

SECTION VII. STORMWATER MANAGEMENT PROGRAM (SWMP) SUMMARY TABLE					
A.	B.	C.	D.	E.	F.
Permit Citation/ SWMP Element	Permit Requirement/Quantifiable SWMP Activity	Number of Activities Performed	Documentation / Record	Entity Performing the Activity	Comments
Part III.A.1 Summary	Provide an evaluation of the Stormwater Management Program according to Part VI.B.2 of the permit.				
	Strengths: Inspections and maintenance have occurred more frequently due to Hurricane and High king Tides.				
	Limitations: No limitations experienced to date for the SWMP protocols.				
	SWMP revisions implemented to address limitations: N/A				
Part III.A.2	Areas of New Development and Significant Redevelopment				
	Report the number of significant development projects, including new and redevelopment, reviewed and approved by the permittee for post-development stormwater considerations.				
	Number of significant development projects reviewed	0	N/A	N/A	N/A
	Number of significant development projects approved	0	N/A	N/A	N/A
	Provide in the Year 2 Annual Report the summary report of the review activity. Provide in the Year 4 Annual Report the follow-up report on plan implementation.				
	Year 2 ONLY: Attach the summary report of the review activity	N/A	N/A	N/A	N/A
	Year 4 ONLY: Attach the follow-up report on plan implementation	N/A	N/A	N/A	N/A
Part III.A.2 Summary	Provide an evaluation of the Stormwater Management Program according to Part VI.B.2 of the permit.				
	Strengths: Inspections and maintenance have occurred more frequently due to Hurricane and High king Tides.				
	Limitations: No limitations experienced to date for the SWMP protocols.				
	SWMP revisions implemented to address limitations: N/A				
Part III.A.3	Roadways				
	Report on the litter control program, including the frequency of litter collection, an estimate of the total number of road miles cleaned or amount of area covered by the activities, and an estimate of the quantity of litter collected.				
	<i>Note: If the permittee does not contract activities, delete CONTRACTOR activities.</i>				
	PERMITTEE Litter Control: Frequency of litter collection	Once Per. Week	Weekly Reports	Public Works	N/A
	PERMITTEE Litter Control: Estimated amount of area maintained (lf)	1.5 miles	Weekly Reports	Public Works	N/A
	PERMITTEE Litter Control: Estimated amount of litter collected (cy)	21.5 cu. Yards.	Weekly Reports	Public Works	1-3 cu. Yd. per. Month due to storms & High King Tides
	CONTRACTOR Litter Control: Frequency of litter collection	N/A	N/A	N/A	N/A
	CONTRACTOR Litter Control: Estimated amount of area maintained (lf)	N/A	N/A	N/A	N/A
	CONTRACTOR Litter Control: Estimated amount of litter collected (cy)	N/A	N/A	N/A	N/A
	OPTIONAL: If an Adopt-A-Road or similar program is implemented, report the total number of road miles cleaned and an estimate of the quantity of litter collected. If you do not participate in an Adopt-A-Road program, report "0".				
	Trash Pick-up Events: Total miles cleaned	N/A	N/A	N/A	N/A
	Trash Pick-up Events: Estimated amount of litter collected (cy)	N/A	N/A	N/A	N/A

SECTION VII. STORMWATER MANAGEMENT PROGRAM (SWMP) SUMMARY TABLE

A.	B.	C.	D.	E.	F.	
Permit Citation/ SWMP Element	Permit Requirement/Quantifiable SWMP Activity	Number of Activities Performed	Documentation / Record	Entity Performing the Activity	Comments	
	Adopt-A-Road: Total miles cleaned	N/A	N/A	N/A	N/A	
	Adopt-A-Road: Estimated amount of litter collected (cy)	N/A	N/A	N/A	N/A	
	Report on the street sweeping program, including the frequency of the sweeping, total miles swept, an estimate of the quantity of sweepings collected, and the total nitrogen and total phosphorus loadings that were removed by the collection of sweepings. If no street sweeping program is implemented, provide the explanation of why not in column F.					
	Frequency of street sweeping	As Required	Weekly Reports	Public Works	More frequent due to storms & high king tides	
	Total miles swept	.5	Weekly Reports	Public Works	N/A	
	Estimated quantity of sweeping material collected (cy / tons)	3.4 cu. Yd.	FSA ASMT Tool	Public Works	N/A	
	Total phosphorous loadings removed (pounds)	1	FSA ASMT Tool	Public Works	N/A	
	Total nitrogen loadings removed (pounds)	1	FSA ASMT Tool	Public Works	N/A	
	Report the equipment yards and maintenances shops that support road maintenance activities, and the number of inspections conducted for each facility.					
	Name of Facility	Number of Inspections				
Streets Department	N/A	N/A	N/A	N/A		
	N/A	N/A	N/A	N/A		
Part III.A.3 Summary	Provide an evaluation of the Stormwater Management Program according to Part VI.B.2 of the permit.					
	Strengths: Inspections and maintenance have occurred more frequently due to Hurricane and High king Tides.					
	Limitations: No limitations experienced to date for the SWMP protocols.					
	SWMP revisions implemented to address limitations: N/A					
Part III.A.4	Flood Control Projects					
	Report the total number of flood control projects that were constructed by the permittee during the reporting period and the number of those projects that did NOT include stormwater treatment. The permittee shall provide a list of the projects where stormwater treatment was not included with an explanation for each of why it was not.					
	Report on any stormwater retrofit planning activities and the associated implementation of retrofitting projects to reduce stormwater pollutant loads from existing drainage systems that do not have treatment BMPs.					
	Flood control projects completed during the reporting period	0	N/A	N/A	N/A	
	Flood control projects completed that did <u>not</u> include stormwater treatment	0	N/A	N/A	N/A	
	Stormwater retrofit projects planned/under construction	0	N/A	N/A	N/A	
	Stormwater retrofit projects completed	0	N/A	N/A	N/A	
If there were projects that did not include stormwater treatment, provide as an attachment a list of the projects and an explanation for each of why it did not.	0	N/A	N/A	N/A		

SECTION VII. STORMWATER MANAGEMENT PROGRAM (SWMP) SUMMARY TABLE					
A.	B.	C.	D.	E.	F.
Permit Citation/ SWMP Element	Permit Requirement/Quantifiable SWMP Activity	Number of Activities Performed	Documentation / Record	Entity Performing the Activity	Comments
Part III.A.4 Summary	Provide an evaluation of the Stormwater Management Program according to Part VI.B.2 of the permit.				
	Strengths: N/A				
	Limitations: N/A				
	SWMP revisions implemented to address limitations: N/A				
Part III.A.5	Municipal Waste Treatment, Storage, and Disposal Facilities Not Covered by an NPDES Stormwater Permit				
	Report the applicable facilities and the number of the inspections conducted for each facility.				
		Name of Facility	Number of Inspections		
	None		N/A	N/A	N/A
Part III.A.5 Summary	Provide an evaluation of the Stormwater Management Program according to Part VI.B.2 of the permit.				
	Strengths: N/A				
	Limitations: N/A				
	SWMP revisions implemented to address limitations: N/A				
Part III.A.6	Pesticides, Herbicides, and Fertilizer Application				
	Report the number of permittee personnel applicators and contracted commercial applicators of pesticides and herbicides who are FDACS certified / licensed. Report the number of permittee personnel who have been trained through the Green Industry BMP Program and the number of contracted commercial applicators of fertilizer who are FDACS certified / licensed.				
	PERSONNEL: FDACS public applicators of pesticides/herbicides	0	N/A	N/A	N/A
	CONTRACTORS: FDACS commercial applicators of pesticides/ herbicides	2	License On File	Hulett Pest Contr. & Zimmerman Tree Service	Town Buildings
	PERSONNEL: Green Industry BMP Program training completed	0	N/A	N/A	N/A
	CONTRACTORS: FDACS certified / licensed applicators of fertilizer	1	License On File	Bass Landscaping	Town Property
	Provide a copy of the adopted ordinance with the Year 2 Annual Report. If this provision is not applicable because the permittee is not within the watershed of a nutrient-impaired water body, indicate that in Column F.				
	Year 2 ONLY: Attach copy of adopted Florida-friendly ordinance	N/A	N/A	N/A	N/A
	Report on the public education and outreach activities that are performed or sponsored by the permittee within the permittee's jurisdiction to encourage citizens to reduce their use of pesticides, herbicides and fertilizers including the type and number of activities conducted, the type and number of materials distributed, and the number of Web site visits (if applicable).				
	Public Education and Outreach Program	The public outreach and education plan is carried out as a joint effort by the Palm Beach County Co-permittees. Please see the Palm Beach County Joint Annual Report for the public education and outreach			

SECTION VII. STORMWATER MANAGEMENT PROGRAM (SWMP) SUMMARY TABLE					
A.	B.	C.	D.	E.	F.
Permit Citation/ SWMP Element	Permit Requirement/Quantifiable SWMP Activity	Number of Activities Performed	Documentation / Record	Entity Performing the Activity	Comments
		information.			
	Brochures/Flyers/Fact sheets distributed	35	Brochures	Town of Palm Beach Shores	Town Hall Display
	Neighborhood presentations: Number conducted	0	N/A	N/A	N/A
	Neighborhood presentations: Number of participants	0	N/A	N/A	N/A
	Newspapers & newsletters: Number of articles/notices published	3	News Letter	Town of Palm Beach Shores	N/A
	Newsletters: Number of newsletters distributed	603	Hard Copies, Town Website	Town of Palm Beach Shores	Postal Service & electronic media
	Public displays (e.g., kiosks, storyboards, posters, etc.)	5	flyers	Town of Palm Beach Shores	Bulletin Boards
	Radio or television Public Service Announcements (PSAs)	0	N/A	N/A	N/A
	School presentations: Number conducted	0	N/A	N/A	N/A
	School presentations: Number of participants	0	N/A	N/A	N/A
	Seminars/Workshops: Number conducted	0	N/A	N/A	N/A
	Seminars/Workshops: Number of participants	0	N/A	N/A	N/A
	Special events: Number conducted	0	N/A	N/A	N/A
	Special events: Number of participants	0	N/A	N/A	N/A
	Number of visitors to stormwater-related pages	0	N/A	N/A	N/A
Part III.A.6 Summary	Provide an evaluation of the Stormwater Management Program according to Part VI.B.2 of the permit.				
	Strengths: N/A				
	Limitations: N/A				
	SWMP revisions implemented to address limitations: N/A				
Part III.A.7.a	Illicit Discharges and Improper Disposal — Inspections, Ordinances, and Enforcement Measures				
	Report amendments in Year 4.				
	Year 4 ONLY: Attach a report on amendments to applicable legal authority				
Part III.A.7.c	Illicit Discharges and Improper Disposal — Investigation of Suspected Illicit Discharges and/or Improper Disposal				
	Report on the proactive inspection program, including the number of inspections conducted by the permittee, the number of illicit activities found, and the number and type of enforcement actions taken.				
	Proactive inspections for suspected illicit discharges	0	SOP Form & DEP Regulations	Code Enforcement & Public Works	Routine Inspections Job Sites
	Illicit discharges found during a proactive inspection	0	N/A	N/A	N/A
	NOV/WL/citation/fines issued for illicit discharges found during proactive inspection	0	N/A	N/A	N/A
	Report on the reactive investigation program as it relates to responding to reports of suspected illicit discharges, including the number of reports received, the				

SECTION VII. STORMWATER MANAGEMENT PROGRAM (SWMP) SUMMARY TABLE					
A.	B.	C.	D.	E.	F.
Permit Citation/ SWMP Element	Permit Requirement/Quantifiable SWMP Activity	Number of Activities Performed	Documentation / Record	Entity Performing the Activity	Comments
	number of investigations conducted, the number of illicit activities found, and the number and type of enforcement actions taken.				
	Reports of suspected illicit discharges received	0	SOP Form & DEP Regulations	Code Enforcement & Public Works	Routine Inspections Job Sites
	Reactive investigations of reports of suspected illicit discharges etc. Illicit discharges etc. found during reactive investigation	0	N/A	N/A	N/A
	NOV/WL/citation/fines issued for illicit discharges etc. found during reactive investigation	0	N/A	N/A	N/A
	Report the type of training activities, and the number of permittee personnel and contractors trained (both in-house and outside training) within the reporting year.				
	Personnel trained	3	Certificates on file	FSA Training & SFWM & FDEP & Table Top	Performing any additional training when available
	Contractors trained	0	N/A	N/A	Contractors not required
Part III.A.7.d	Illicit Discharges and Improper Disposal — Spill Prevention and Response				
	Report on the spill prevention and response activities, including the number of spills addressed.				
	Hazardous and non-hazardous material spills responded to	0	N/A	N/A	N/A
	Report the type of training activities, and the number of permittee personnel and contractors trained (both in-house and outside training) within the reporting year.				
	Personnel trained	26	Fire Department	Public Works & Fire Dept.	Table Top & outside contractor
	Contractors trained	0	N/A	N/A	N/A
Part III.A.7.e	Illicit Discharges and Improper Disposal — Public Reporting				
	Report on the public education and outreach activities that are performed or sponsored by the permittee within the permittee's jurisdiction to encourage the public reporting of suspected illicit discharges and improper disposal of materials, including the type and number of activities conducted, the type and number of materials distributed, and the number of Web site visits (if applicable).				
	Public Education and Outreach Program	The public outreach and education plan is carried out as a joint effort by the Palm Beach County Co-permittees. Please see the Palm Beach County Joint Annual Report for the public education and outreach information.			
	Brochures/Flyers/Fact sheets distributed	22	Town Hall	Town Hall	N/A
	Neighborhood presentations: Number conducted	4	Public Works & Fire Dept.	Storm Water and me, PBC Storm Water System Group, PBCSWA, FDEP	N/A

SECTION VII. STORMWATER MANAGEMENT PROGRAM (SWMP) SUMMARY TABLE					
A.	B.	C.	D.	E.	F.
Permit Citation/ SWMP Element	Permit Requirement/Quantifiable SWMP Activity	Number of Activities Performed	Documentation / Record	Entity Performing the Activity	Comments
	Neighborhood presentations: Number of participants	10	Fire Dept.	Public Works & Fire Dept.	N/A
	Newspapers & newsletters: Number of articles/notices published	3	Town Hall	Town of palm Beach Shores	N/A
	Newsletters: Number of newsletters distributed	603	Town Hall	Town of palm Beach Shores	N/A
	Public displays (e.g., kiosks, storyboards, posters, etc.)	3	Town Hall	Town of palm Beach Shores	N/A
	Radio or television Public Service Announcements (PSAs)	0	N/A	N/A	N/A
	School presentations: Number conducted	0	N/A	N/A	N/A
	School presentations: Number of participants	0	N/A	N/A	N/A
	Seminars/Workshops: Number conducted	0	N/A	N/A	N/A
	Seminars/Workshops: Number of participants	0	N/A	N/A	N/A
	Special events: Number conducted	0	N/A	N/A	N/A
	Special events: Number of participants	0	N/A	N/A	N/A
	Number of visitors to stormwater-related pages	0	N/A	N/A	N/A
Part III.A.7.f	Illicit Discharges and Improper Disposal — Oils, Toxics, and Household Hazardous Waste Control				
	Report on the public education and outreach activities that are performed or sponsored by the permittee within the permittee's jurisdiction to encourage the proper use and disposal of oils, toxics, and household hazardous waste, including the type and number of activities conducted, the type and number of materials distributed, the amount of waste collected / recycled / properly disposed, and the number of Web site visits (if applicable).				
	Public Education and Outreach Program	The public outreach and education plan is carried out as a joint effort by the Palm Beach County Co-permittees. Please see the Palm Beach County Joint Annual Report for the public education and outreach information.			
	Brochures/Flyers/Fact sheets distributed	0	N/A	N/A	N/A
	Neighborhood presentations: Number conducted	0	N/A	N/A	N/A
	Neighborhood presentations: Number of participants	0	N/A	N/A	N/A
	Newspapers & newsletters: Number of articles/notices published	0	N/A	N/A	N/A
	Newsletters: Number of newsletters distributed	0	N/A	N/A	N/A
	Public displays (e.g., kiosks, storyboards, posters, etc.)	0	N/A	N/A	N/A
	Radio or television Public Service Announcements (PSAs)	0	N/A	N/A	N/A
	School presentations: Number conducted	0	N/A	N/A	N/A
	School presentations: Number of participants	0	N/A	N/A	N/A
	Seminars/Workshops: Number conducted	0	N/A	N/A	N/A
	Seminars/Workshops: Number of participants	0	N/A	N/A	N/A
	Special events: Number conducted	0	N/A	N/A	N/A
	Special events: Number of participants	0	N/A	N/A	N/A
	Storm sewer inlets newly marked/replaced	0	N/A	N/A	N/A
	Number of visitors to stormwater-related pages	0	N/A	N/A	N/A

SECTION VII. STORMWATER MANAGEMENT PROGRAM (SWMP) SUMMARY TABLE							
A.	B.			C.	D.	E.	F.
Permit Citation/ SWMP Element	Permit Requirement/Quantifiable SWMP Activity			Number of Activities Performed	Documentation / Record	Entity Performing the Activity	Comments
Part III.A.7.g	Illicit Discharges and Improper Disposal — Limitation of Sanitary Sewer Seepage						
	Report on the type and number of activities undertaken to reduce or eliminate SSOs and inflow/ infiltration, the number of SSOs or inflow / infiltration incidents found and the number resolved, and the name of the owner of the sanitary sewer system within the permittee's jurisdiction. Report only the SSOs and inflow / infiltration incidents into the MS4.						
	Owner of the sanitary sewer system			Town of Palm Beach Shores pumps to the City of Riviera Beach facility.			
	Activity to reduce/eliminate SSOs and I&I: (description)			0	City of Riviera Beach	City of Riviera Beach	N/A
	Activity to reduce/eliminate SSOs and I&I: (description)			0	N/A	N/A	N/A
	SSO incidents discovered			0	N/A	N/A	N/A
	SSO incidents resolved			0	N/A	N/A	N/A
	Inflow / infiltration incidents discovered			0	N/A	N/A	N/A
	Inflow / infiltration incidents resolved			0	N/A	N/A	N/A
Part III.A.7 Summary	For activities required by Part III.A.7: Provide an evaluation of the Stormwater Management Program according to Part VI.B.2 of the permit.						
	Strengths: N/A						
	Limitations: N/A						
	SWMP Revisions implemented to address limitations: N/A						
Part III.A.8.a	Industrial and High-Risk Runoff — Identification of Priorities and Procedures for Inspections						
	Report on the high-risk facilities inventory, including the type and total number of high risk facilities and the number of facilities newly added each year. Report on the high-risk facilities inspection program, including the number of inspections conducted and the number and type of enforcement actions taken.						
	Type of Facility	Number of Facilities	Number of Inspections	Enforcement Actions			
	Operating municipal landfills	0	N/A	N/A	N/A	N/A	N/A
	Hazardous waste treatment, storage, disposal and recovery (HWTSDR) facilities	0	N/A	N/A	N/A	N/A	N/A
	EPCRA Title III, Section 313 facilities (TRI)	0	N/A	N/A	N/A	N/A	N/A
	Facilities determined as high risk by the permittee	0	N/A	N/A	N/A	N/A	N/A
Part III.A.8.b	Industrial and High-Risk Runoff — Monitoring for High Risk Industries						
	Report the number of high risk facilities sampled.						
	High risk facilities sampled	0			N/A	N/A	N/A

SECTION VII. STORMWATER MANAGEMENT PROGRAM (SWMP) SUMMARY TABLE					
A.	B.	C.	D.	E.	F.
Permit Citation/ SWMP Element	Permit Requirement/Quantifiable SWMP Activity	Number of Activities Performed	Documentation / Record	Entity Performing the Activity	Comments
Part III.A.8 Summary	Provide an evaluation of the Stormwater Management Program according to Part VI.B.2 of the permit.				
	Strengths: N/A				
	Limitations: N/A				
	SWMP revisions implemented to address limitations: N/A				
Part III.A.9.a	Construction Site Runoff — Site Planning and Non-Structural and Structural Best Management Practices				
	Report the number of permittee and private pre-construction site plans reviewed for stormwater, erosion, and sedimentation controls, and the number approved.				
	PERMITTEE SITES: Construction site plans reviewed	0	N/A	N/A	N/A
	PERMITTEE SITES: Construction site plans approved	0	N/A	N/A	N/A
	PRIVATE SITES: Construction site plans reviewed	21	Planning & Zoning	Safe built Inspection	Single Family Homes & Condos
	PRIVATE SITES: Construction site plans approved	21	Planning & Zoning	Safe built Inspection	Single Family Homes & Condos
	Report the number of development permit applicants notified of the ERP and CGP, and the number of applicants who confirmed ERP and CGP coverage.				
	Notified of ERP stormwater permit requirements	0	N/A	N/A	N/A
	Confirmed ERP coverage	0	N/A	N/A	N/A
	Notified of CGP stormwater permit requirements	0	N/A	N/A	N/A
	Confirmed CGP coverage	0	N/A	N/A	N/A
Part III.A.9.b	Construction Site Runoff — Inspection and Enforcement				
	Report on the inspection program for privately-operated and permittee-operated construction sites, including the number of active construction sites during the reporting year, the number of inspections of active construction sites, the percentage of active construction sites inspected, and the number and type of enforcement actions / referrals taken.				
	PERMITTEE SITES: Active construction sites	3	Planning & Zoning	Safe built Inspection	Single Family Homes & Condos
	PERMITTEE SITES: Pre-, During, and Post inspections of active construction sites for E&S and waste control BMPs	3	Planning & Zoning	Safe built Inspection	Single Family Homes & Condos
	PERMITTEE SITES: Percentage of active construction sites inspected	100	Planning & Zoning	Safe built Inspection	Single Family Homes & Condos
	PRIVATE SITES: Active construction sites	1	Construction Inspections Reports	Safe built Inspection	Single Family Homes & Condos
	PRIVATE SITES: Pre-, During, and Post inspections of active construction sites for E&S and waste control BMPs	12	Construction Inspections Reports	Safe built Inspection	Single Family Homes & Condos

SECTION VII. STORMWATER MANAGEMENT PROGRAM (SWMP) SUMMARY TABLE						
A.	B.		C.	D.	E.	F.
Permit Citation/ SWMP Element	Permit Requirement/Quantifiable SWMP Activity		Number of Activities Performed	Documentation / Record	Entity Performing the Activity	Comments
	PRIVATE SITES: Percentage of active construction sites inspected		100	Construction Inspections Reports	Safe built Inspection	Single Family Homes & Condos
	Enforcement Action		0	Construction Inspections Reports	N/A	N/A
Part III.A.9.c	Construction Site Runoff — Site Operator Training					
	Report the type of training activities, the number of inspectors, site plan reviewers and site operators trained (both in-house and outside training).					
		DEP Certification	Annual Training			
	Permittee construction site inspectors	2	2	Inspector Certification	Safe built Inspection & Public Works Director	N/A
	Permittee construction site plan reviewers	1	1	Inspector	Safe built Inspection	N/A
	Permittee construction site operators	1	1	Inspector	Safe built Inspection	N/A
Part III.A.9 Summary	Provide an evaluation of the Stormwater Management Program according to Part VI.B.2 of the permit.					
	Strengths: Regular Training & Continuing Education.					
	Limitations: None					
	SWMP revisions implemented to address limitations: None					

SECTION VIII. CHANGES TO THE STORMWATER MANAGEMENT PROGRAM (SWMP) ACTIVITIES (Not Applicable in Year 4)

A.	Permit Citation/ SWMP Element	Proposed Changes to the Stormwater Management Program Activities Established as Specific Requirements Under Part III.A of the Permit (Including the Rationale for the Change) — REQUIRES DEP APPROVAL PRIOR TO CHANGE IF PROPOSING TO REPLACE OR DELETE AN ACTIVITY.
		None at this time always under review.
B.	Permit Citation/ SWMP Element	Changes to the Stormwater Management Program Activities NOT Established as Specific Requirements Under Part III.A of the Permit (Including the Rationale for the Change)
		None at this present time always under review.

SECTION IX. TMDL Status Report

A.	YEAR 1 Provide a table summarizing the status of the TMDL process. Include a list of prioritized TMDLs and their monitoring and implementation schedule; and include the Identification number of the outfall prioritized for TMDL monitoring.								
	WBID Number	Segment/ Waterbody/ Basin	Pollutant of Concern	TMDL DEP / EPA	Percent Reduction (WLA)	Priority Rank	Priority Outfall	Monitoring Summary / BPCP Due Date	Supplemental SWMP Due Date
	N/A			<input type="checkbox"/> / <input type="checkbox"/>		1		(Year 3 AR)	(Year 4 AR; N/A) if BPCP)
				<input type="checkbox"/> / <input type="checkbox"/>					
B.	YEAR 3 and annually thereafter, provide a summary of the estimated load reductions that have occurred for the pollutant(s) of concern being discharged from the MS4 to the TMDL water body during the reporting period and cumulatively since the date the Supplemental SWMP was implemented. Year 3: Submit a Monitoring data summary or BPCP (if applicable). Year 4: Submit a Supplemental SWMP (if applicable).								
	WBID Number	Pollutant of Concern	Monitoring Summary / BPCP Submitted	Supplemental SWMP Submitted	Projected load reductions OR Actual load reductions to date				
	N/A		(Year 3 AR)	(Year 4 AR; N/A if BPCP)					
C.	Provide a brief statement as to the status of TMDL implementation according to Part VIII.B of the permit (e.g. status of monitoring to validate WLA): No discharge to TMDL WBID at the time of permit issuance.								

Town of Palm Beach Shores Townwide Stormwater

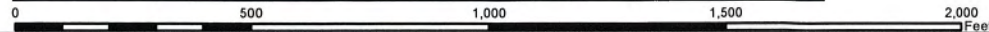
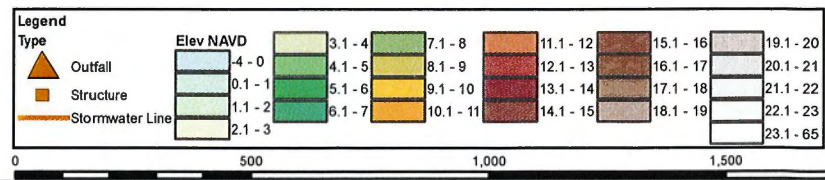
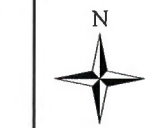
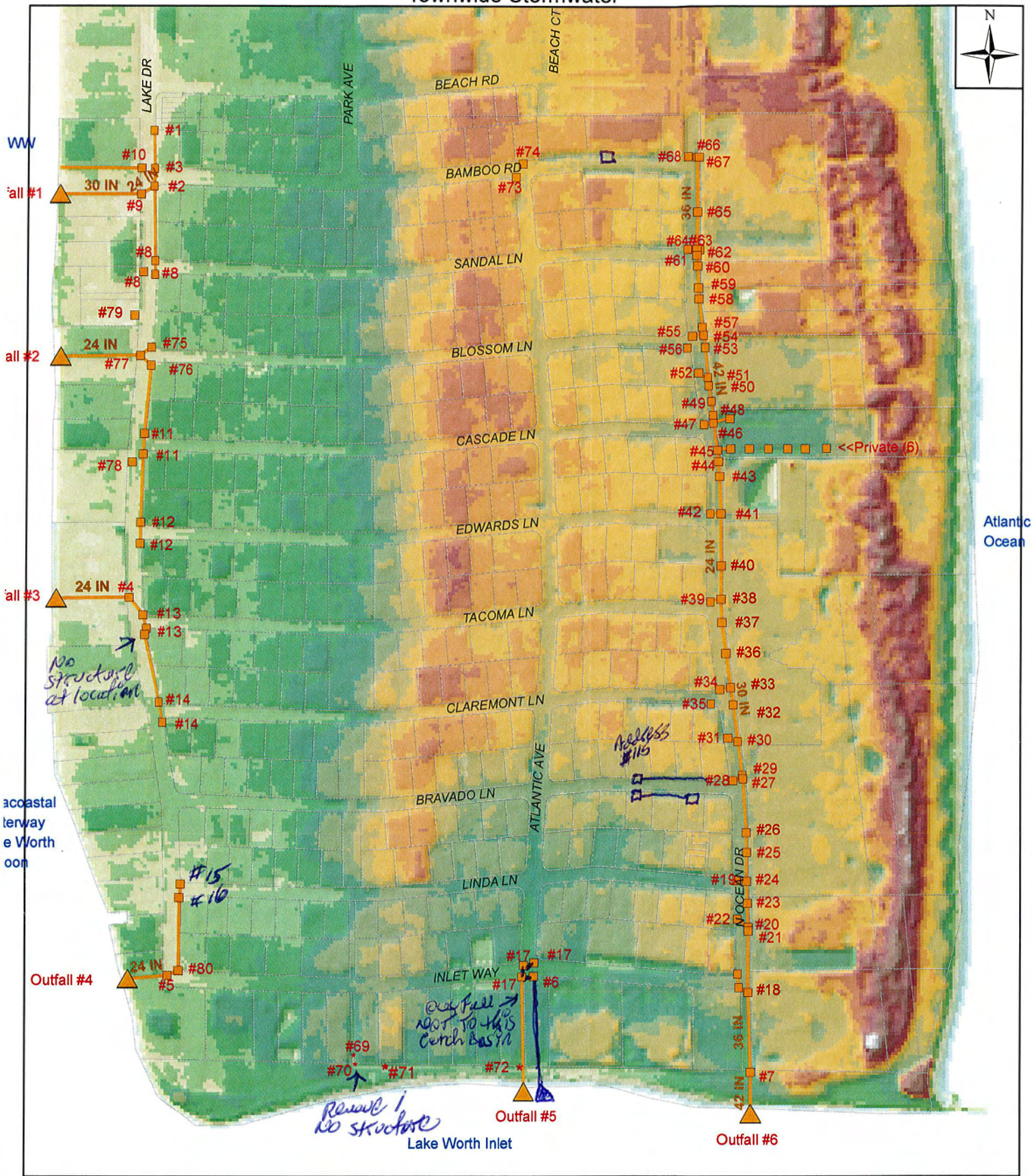

PBS #	Location	Grate size	Description (first 16 from Inspection Reports provided to Joan)
1	NE side of Lake Dr north of Bamboo intersection (JVS changed description of location)		CB discharges into ICWW behind condo @ NW side of Lake Dr & Bamboo Rd intersection
2	SE side of Lake Dr & Bamboo Rd intersection		CB discharges into ICWW via easement between two houses west of the Lake Dr/Bamboo Rd intersection. Pipe discharges from seawall
3	NE corner of Lake Dr and Bamboo Rd intersection		CB discharges into ICWW west of catch basin. Outfall pipe runs between two houses and discharges at the seawall
4	W of Lake Dr & Tacoma intersection		CB within the Sailfish Marina north parking lot, outfall is located @ the seawall into the ICWW via a 24" pipe
5	W side of Lake Dr & Inlet Way intersection		CB discharges to ICWW at the seawall via a 24" pip, west of the CB
6	SE corner of Atlantic Ave and Inlet Way		CB discharges via 36" pipe to Inlet/ICWW within the jetty rocks
7	South end of Ocean Ave by vehicle gate entrance		CD discharges ia 42" pipe to Inlet/ICWW on seawall
8	NE, SE & W sides of Lake Dr & Sandal Ln intersection (3)		Three interconnected CBs discharge to the ICWW behind condo @ NW side of Lake Dr & Bamboo Rd intersection
9	220 Lake Dr - NE corner		CB discharges to the ICWW at end of town
10	NW side of Lake Dr & Bamboo intersection		CB discharges to the ICWW west of intersection
11	NE & SE sides of Lake Dr & Cascade intersection (2)		Two CBs discharge to the ICWW west of interseccion
12	NE & SE sides of Lake Dr Edwards Ln intersection (2)		Two CBs discharge to the ICWW west of interseccion
13	NE & SE sides of Lake Dr & Tacoma Ln intersection (2)		Two CDs discharge to the ICWW at outflow in Sailfish Marina
	There is a marker on the map just south of #13 that I don't see on "street view" ✓		
14	NE & SE sides of Lake Dr & Claremont Ln intersection (2)		Two CBs discharge to the ICWW
15	NE & SE sides of Lake Dr & Linda Ln intersection (2) (inspect form - same as #16)		Two CBs discharge to the ICWW
16	NE side of Lake Dr & Linda Ln intersection (from inspect form - same as #15) ✓ <i>Remove</i>		CB discharges to seawall west of basin to ICWW
17	NE & NW & SW intersection of Atlantic/Inlet Way (3) <i>Keep</i>		took out SE to keep in #6
18	SW & SE corners of Ocean/Inlet (2)		
	south end of Ocean Ave by Inlet (same as #7?)	4.4' x 3.4'	
	east side of Ocean Ave at Inlet Park entry gate (same as one of #18?)	4.4' x 3.4'	
	west side of ocean ave at south side of Linda Lane (not one there)	2.4' x 3'	nothing there
19	west side of Ocean Ave at corner of Linda Ln	2.4' x 3'	
20	east side of Ocean Ave south side of 33 Ocean Ave just south of [item below]	3' x 2'	
21	east side of Ocean Ave south side of 33 Ocean Ave just north of [item above]	4.4' x 3'	
22	west side of Ocean Ave across from 33 Ocean Ave	2.4' x 3'	
23	east side of Ocean Ave north side of 33 Ocean Ave	2.4' x 3'	
24	east side of Ocean Ave across from Linda Ln	4.4' x 3.4'	
	west side of Ocean Ave at NE corner of Linda Ln (see #19)	3' x 2.4'	not a good location - one at NW corner only
25	east side of Ocean Ave south end of Marriot	3' x 2.4'	[s of Bravado]
26	east side of Ocean Ave between Linda & Bravado in front of Marriott	4.4' x 3.4'	[south of Bravado]
27	east side of Ocean Ave at end of Bravado in front of Marriott	4.4 x 3'	
28	west side of Ocean Ave at end of Bravado in front of Marriot	2.4' x 3'	
29	east side of Ocean Ave just north of #27 in front of Marriot	2.4' x 3'	

PBS #	Location	Grate size	Description (first 16 from Inspection Reports provided to Joan)
30	east side of Ocean Ave between Bravado and Claremont Ln in front of Marriot	4.4' x 3'	
31	west side of Ocean Ave across from #30 in front of Marriot	2.6' x 2.4'	
32	east side of Ocean Ave at end of Claremont Ln in front of Marriot	2.4' x 3'	
33	east side of Ocean Ave north of Claremont Ln in front of Marriot	4.4' x 3'	
34	west side of Ocean Ave north of Claremont Ln across in front of Marriot	3' x 2.4'	
35	south side of Claremont Ln west of Ocean		
36	east side of Ocean Ave between Tacoma & Claremont Ln in front of Marriot	4.4' x 3'	big one at Marriot entrance
37	east side of Ocean Ave just south of Tacoma Ln in front of Marriot	2.4' x 3'	
38	east side of Ocean Ave just north of Tacoma Ln in front of Marriot	4' x 3'	
39	west side of Ocean Ave just north of Tacoma Lane in front of Marriot	2.4' x 3'	
40	east side of Ocean Ave between Tacoma and Edwards Lane in front of Marriott	2.4' x 3'	
41	east side of Ocean Ave just north of Edwards Lane in front of Seapray Inn	2.4' x 3'	
42	west side of Ocean Ave just north of Edwards Ln in front of Seaspray Inn	2.4' x 3'	
43	east side of Ocean Ave between Cascade and Edwards Lane in front of Seaspray Inn	2.4 x 3'	
44	east side of Ocean Ave between Seaspray Inn & Mayan South	2.4' x 3'	
45	east side of Ocean Ave in front of Mayan South	2.4; x 3'	
	private - Mayan South parking lot south side leads into #45	2.1' x 2.1'	
46	east side of Ocean Ave just north of Cascade Ln in front of Mayan South	2.4' x 3'	at north entrance
47	west side of Ocean Ave just north of Cascade Lane in front of Mayan South	2.4' x 3'	
	Private - Mayan South parking lot north side leads into [item two above] - I don't see this on the drainage map	2.1' x 2.1'	
48	east side of Ocean Ave north of Cascade Ln north of #46	2.4' x 3'	at entrance
49	east side of Ocean Ave between Cascade and Blossom Ln	2.4' x 3'	grassy small
50	east side of Ocean Ave between Cascade and Blossom Ln north of #49	2.4' x 3'	grassy small
51	east side of Ocean Ave between Cascade and Blossom Ln north of #50	2.5' x 1.6'	at entrance
52	west side of Ocean Ave south of Blossom Ln in front of 106 Blossom	2.4' x 3'	
53	east side of Ocean Ave at end of Blossom Ln	2.4' x 3'	at driveway south
54	east side of Ocean Ave north of Blossom Ln	2.4' x 3'	at north driveway
55	west side of Ocean Ave north of Blossom Ln	2.4' x 3'	
56	south side of Blossom west of Ocean Ave		
57	east side of Ocean Ave north of Blossom Ln north of #54	2.4' x 3'	at south of exit
58	east side of Ocean Ave between Sandal and Blossom Ln	3' x 2.4'	at north of exit
59	east side of Ocean Ave between Sandal and Blossom Ln north of #58	3' x 2.4'	at park lot
60	east side of Ocean Ave south of Sandal Ln	2.4' 3'	
61	east side of Ocean Ave at end of Sandal Ln	2.4' x 3'	
62	east side of Ocean Ave north of Sandal Ln	2.4' x 3'	
63	east side of Ocean Ave north of Sandal Ln just east of #62	2.4' x 3'	
64	west side of Ocean Ave north of Sandal Ln	2.4' x 3'	

PBS #	Location	Grate size	Description (first 16 from Inspection Reports provided to Joan)
65	east side of Ocean Ave between Sandal and Bamboo Ln	4.4' x 3.4'	
66	east side of Ocean Ave north of Bamboo Ln	4.4' x 3.3'	
67	east side of Ocean Ave north of Bamboo Ln just east of #66	2.5' x 3.8'	
68	west side of Ocean Ave north of Bamboo Ln	2.4' x 3'	
69	Parkway north of Inlet Park		
70	southernmost Parkway at Inlet Park		
71	west of Parkway in Inlet Park		
72	west of outfall pipe in Inlet Park		
73	SW corner of Bamboo & Atlantic		
74	north side of Bamboo at Atlantic		in grass by hydrant
75	NE corner of Lake & Blossom		
76	SE corner of Lake & Blossom		
77	west side of Lake Dr at Blossom		
78	west side of Lake Dr south of Cascade		
79	west side of Lake Dr between Sandal and Blossom		
80	NE corner of Lake & Inlet Way		
	Outfall #1 - ICWW west of Bamboo Rd		
	Outfall #2 - ICWW west of Blossom Lane		
	Outfall #3 - ICWW just north of Tacoma Lan		
	Outfall #4 - ICWW west of Inlet Way		
	Outfall #5 - Lake Worth Inlet, south of Atlantic Ave		
	Outfall #6 - Lake Worth Inlet, south of Ocean Dr		