



Annual Report Form For Individual NPDES Permits For Municipal Separate Storm Sewer Systems (RULE 62-624.600(2), F.A.C.)

- This Annual Report Form must be completed and submitted to the Department to satisfy the annual reporting requirements established in Rule 62-621.600, F.A.C.
- Submit this fully completed and signed form and any REQUIRED attachments by email to the NPDES Stormwater Program Administrator or to the MS4 coordinator (<http://www.dep.state.fl.us/water/stormwater/npdes/contacts.htm>). Files larger than 10MB may be placed on the FTP site at: ftp://ftp.dep.state.fl.us/pub/NPDES_Stormwater/. After uploading files, email the MS4 coordinator or NPDES Program Administrator to notify them the report is ready for downloading; or by mail to the address in the box at right.
- Refer to the Form Instructions for guidance on completing each section.
- **Please print or type information in the appropriate areas below.**

Submit the form and attachments to:
 Florida Department of Environmental Protection
 Mail Station 3585
 2600 Blair Stone Road
 Tallahassee, Florida 32399-2400

SECTION I. BACKGROUND INFORMATION	
A.	Permittee Name: Town of Gulf Stream
B.	Permit Name: Palm Beach County MS4
C.	Permit Number: FLS000018-004
D.	Annual Report Year: <input checked="" type="checkbox"/> Year 1 <input type="checkbox"/> Year 2 <input type="checkbox"/> Year 3 <input type="checkbox"/> Year 4 <input type="checkbox"/> Year 5 <input type="checkbox"/> Other, specify Year:
E.	Reporting Time Period (month/year): October / 2016 through September / 2017
F.	Name of the Responsible Authority: Greg Dunham
	Title: Town Manager
	Mailing Address: 100 Sea Road
	City: Gulf Stream Zip Code: 33483 County: Palm Beach
	Telephone Number: 561-276-5116 Fax Number: 561-737-0188
	E-mail Address: gdunham@gulf-stream.org
G.	Name of the Designated Stormwater Management Program Contact (if different from Section I.F above):
	Title:
	Department:
	Mailing Address:
	City: Zip Code: County:
	Telephone Number: Fax Number:
	E-mail Address:

SECTION II. MS4 MAJOR OUTFALL INVENTORY (Not Applicable in Year 1)	
A.	Number of outfalls ADDED to the outfall inventory in the current reporting year (insert "0" if none): 0 (Does this number include non-major outfalls? <input type="checkbox"/> Yes <input type="checkbox"/> No <input checked="" type="checkbox"/> Not Applicable)
B.	Number of outfalls REMOVED from the outfall inventory in the current reporting year (insert "0" if none): 0 (Does this number include non-major outfalls? <input type="checkbox"/> Yes <input type="checkbox"/> No <input checked="" type="checkbox"/> Not Applicable)
C.	Is the change in the total number of outfalls due to lands annexed or vacated? <input type="checkbox"/> Yes <input type="checkbox"/> No <input checked="" type="checkbox"/> Not Applicable

SECTION III. PART V.B. ASSESSMENT PROGRAM

<p>A.</p>	<p>Provide a brief statement as to the status of water quality monitoring plan implementation. Status may include sampling frequency changes, monitoring location changes, or sampling waiver conditions. <u>DEP Note:</u> If permittee participates in a collaborative monitoring plan, permittee may refer to a joint response as defined by the interlocal agreement.</p> <p>Name and date of the approved plan: <i>Current approved plan for the Group Monitoring Plan is September 8, 2016 (with issuance of the Cycle 4 permit). Our newly-developed, individual Assessment Plan was submitted on 9/8/17.</i></p> <p>Status: <i>The Group Monitoring Report is included in the Cycle 4, Year 1 Joint Annual Report. The newly-developed, individual Assessment Plan is awaiting approval by FDEP.</i></p>
<p>B.</p>	<p>Provide a brief discussion of the monitoring and loading results to date which includes a summary of the water quality monitoring data and / or stormwater pollutant loading changes from the reporting year. <u>DEP Note:</u> Results must be specific to the permittee's SWMP.</p> <p><i>Please refer to the Cycle 4, Year 1 Joint Annual Report for a summary of the Group's water quality monitoring results for the reporting period. Refer to the Cycle 3, Year 6 Joint Annual Report for proposed pollutant loading analysis changes. The best available information on existing pollutant loading estimates is documented in the Cycle 3, Year 3 Joint Annual Report.</i></p> <p><i>The newly-developed, individual Assessment Plan is under review by FDEP and will be implemented during Year 2 of the permit cycle. Note that in any future reporting year, the Group's water quality monitoring data for the reporting period may not be available for 4 to 6 months after the reporting period has ended. Consequently, any water quality data from the Group Program that is used as part of an individual permittee's Assessment Plan for the reporting period, will be based on the previous year's data.</i></p>
<p>C.</p>	<p>Attach a monitoring data summary as required by the permit. An analysis of the data discussing changes in water quality and/or stormwater pollutant loading from previous reporting years. <u>DEP Note:</u> Analysis must be specific to the permittee's SWMP.</p> <p><i>See response for Section III.B., above.</i></p>

SECTION IV. FISCAL ANALYSIS

<p>A.</p>	<p>Total expenditures for the NPDES stormwater management program for the current reporting year: \$43,650</p>
<p>B.</p>	<p>Total budget for the NPDES stormwater management program for the subsequent reporting year: \$41,500</p>
<p>C.</p>	<p>Did subsequent program resources decrease from the current reporting period? Y <input checked="" type="checkbox"/> / N <input type="checkbox"/></p> <p>If program resources decreased, provide a discussion of the impacts on the implementation of the SWMP.</p> <p>The budget for the subsequent year only decreased by \$2,150. For 2015-2016 reporting year, the Town budgeted \$43,650, but only spent \$29,902. The Town's budget of \$41,500 for 2017-2018 should be sufficient and there should be no significant impact on the implementation of the SWMP.</p>

SECTION V. MATERIALS TO BE SUBMITTED WITH THIS ANNUAL REPORT FORM

Only the following materials are to be submitted to the Department along with this fully completed and signed Annual Report Form (check the appropriate box to indicate whether the item is attached or is not applicable):

Attached	N/A	Required Attachments	Permit Citation	Attachment Number/Title
<input type="checkbox"/>	<input checked="" type="checkbox"/>	Any additional information required to be submitted in this current annual reporting year in accordance with Part III.A of your permit that is not otherwise included in Section VII below.	Part III.A	
<input type="checkbox"/>	<input checked="" type="checkbox"/>	If program resources have decreased from the previous year, a discussion of the impacts on the implementation of the SWMP.	Part II.F	
<input type="checkbox"/>	<input checked="" type="checkbox"/>	An explanation of why the minimum inspection frequency in Table II.A.1.a. was not met, if applicable.	Part II.A.1	
<input type="checkbox"/>	<input checked="" type="checkbox"/>	A list of the flood control projects that did not include stormwater treatment and an explanation for each of why it did not (if applicable).	Part III.A.4	
<input checked="" type="checkbox"/>	<input type="checkbox"/>	A monitoring data summary as directed in Section III.C above and in accordance with Rule 62-624.600(2)(c), F.A.C.	Part VI.B.2.	Refer to Joint Report
<input checked="" type="checkbox"/>	<input type="checkbox"/>	YEAR 1 ONLY: An inventory of all known major outfalls and a map depicting the location of the major outfalls (hard copy or CD-ROM) in accordance with Rule 62-624.600(2)(a), F.A.C.	Part III.A.1	Attachment #1: Maps & Inventories (All outfalls inventoried)
<input type="checkbox"/>	<input checked="" type="checkbox"/>	YEAR 2: A summary review of codes and regulations to reduce the stormwater impact from development.	Part III.A.2	
<input type="checkbox"/>	<input checked="" type="checkbox"/>	Year 3 ONLY: The estimates of pollutant loadings and event mean concentrations for each major outfall or each major watershed in accordance with Rule 62-624.600(2)(b), F.A.C.	Part V.A	
<input type="checkbox"/>	<input checked="" type="checkbox"/>	YEAR 3: Summary of TMDL Monitoring Results (if applicable).	Part VIII.B.2	
<input type="checkbox"/>	<input checked="" type="checkbox"/>	YEAR 3: Bacteria Pollution Control Plan (if applicable).	Part VIII.B.3	
<input type="checkbox"/>	<input checked="" type="checkbox"/>	YEAR 4: A follow-up report on plan implementation of changes to codes and regulations to reduce the stormwater impact from development.	Part III.A.2	
<input type="checkbox"/>	<input checked="" type="checkbox"/>	YEAR 4: A report on any amendments to the applicable legal authority (if applicable).	Part III.A.7.a	
<input type="checkbox"/>	<input checked="" type="checkbox"/>	YEAR 4: Permit re-application information in accordance with Rule 62-624.420(2), F.A.C. <ul style="list-style-type: none"> The monitoring plan (with revisions, if applicable). If the total annual pollutant loadings have not decreased over the past two permit cycles, revisions to the SWMP, as appropriate. 	Part V.B.3 Part V.A.3	
<input type="checkbox"/>	<input checked="" type="checkbox"/>	YEAR 4: TMDL Supplemental SWMP (if applicable).	Part VIII.B.3	

DO NOT SUBMIT ANY OTHER MATERIALS
(such as records and logs of activities, monitoring raw data, public outreach materials, etc.)

SECTION VI. CERTIFICATION STATEMENT AND SIGNATURE

The Responsible Authority listed in Section I.F above must sign the following certification statement, as per Rule 62-620.305, F.A.C.:

I certify under penalty of law that this document and all attachments were prepared under my direction or supervision in accordance with a system designed to assure that qualified personnel properly gathered and evaluated the information submitted. Based upon my inquiry of the person or persons who manage the system, or those persons directly responsible for gathering the information, the information submitted is, to the best of my knowledge and belief, true, accurate and complete. I am aware that there are significant penalties for submitting false information, including the possibility of fine and imprisonment for knowing violations.

Name of Responsible Authority (type or print): Greg Dunham

Title: Town Manager, Town of Gulf Stream

Signature: 

Date: 01/29/2018

SECTION VII. STORMWATER MANAGEMENT PROGRAM (SWMP) SUMMARY TABLE

A.	B.					C.	D.	E.	F.
Permit Citation/ SWMP Element	Permit Requirement/Quantifiable SWMP Activity					Number of Activities Performed	Documentation / Record	Entity Performing the Activity	Comments
Part III.A.1	Structural Controls and Stormwater Collection Systems Operation								
<p>Report the current known inventory.</p> <p>Report the number of inspection and maintenance activities conducted for each applicable type of structure included in Table II.A.1.a, and the percentage of the total inventory of each type of structure inspected and maintained.</p> <p><i>Note: Delete structures that are not in your MS4's inventory. The permittee may choose its own unit of measurement for each structural control to be consistent with the unit of measurement in the documentation. Unit options include: miles, linear feet, acres, etc.</i></p>									
Type of Structure		Number of Structures	Number of Inspections	Percent Inspected	Number of Maintenance Activities	Percent Maintained	Documentation / Record	Entity Performing the Activity	Comments
Grass treatment swales (miles)		0.97	12	100%	0	100%	Maintenance Log – Catch Basins, Grates, Roadside Ditches	Town Staff (B. Dietrick, W. Songer)	No maintenance required
Stormwater Pump Stations		1	47	100%	4	100%	Outfall Maintenance Log Sheet and Generator Maintenance Log	Town Staff (B. Dietrick)	
Major outfalls		0	N/A	N/A	N/A	N/A	N/A	N/A	All 17 outfalls inspected monthly. None are major outfalls
Weirs or other control structures		1	0	0%	0	N/A	Outfall Maintenance Log Sheet	Town Staff (B. Dietrick)	Inspected monthly with outfalls
Pipes / Culverts (miles)		1.34	12	30%	0	N/A	Maintenance Log – Catch Basins, Grates, Roadside Ditches	Town Staff (B. Dietrick, W. Songer)	Inspect all inlet monthly and associated pipes at inlets
Inlets / catch basins / grates		87	12	100%	12	100%	Maintenance Log – Catch Basins, Grates, Roadside Ditches	Town Staff (B. Dietrick, W. Songer)	Inspected monthly and clean as needed
If the minimum inspection frequencies set forth in Table II.A.1.a. were not met, provide as an attachment an explanation of why they were not and a description of the actions that will be taken to ensure that they will be met.					N/A		N/A	N/A	Minimum Inspection Frequencies Met

SECTION VII. STORMWATER MANAGEMENT PROGRAM (SWMP) SUMMARY TABLE

A.	B.	C.	D.	E.	F.
Permit Citation/ SWMP Element	Permit Requirement/Quantifiable SWMP Activity	Number of Activities Performed	Documentation / Record	Entity Performing the Activity	Comments
Part III.A.1 Summary	Provide an evaluation of the Stormwater Management Program according to Part VI.B.3 of the permit.				
	Strengths: Town completes minimum of monthly inspections on all inlets.				
	Limitations: None.				
	SWMP revisions implemented to address limitations: N/A				
Part III.A.2	Areas of New Development and Significant Redevelopment				
	Report the number of significant development projects, including new and redevelopment, reviewed and approved by the permittee for post-development stormwater considerations.				
	Number of significant development projects reviewed	0	2017 Architectural Review & Planning Board File Log		All projects submitted under 1 ac. (not significant)
	Number of significant development projects approved	N/A	N/A		
	Provide in the Year 2 Annual Report the summary report of the review activity. Provide in the Year 4 Annual Report the follow-up report on plan implementation.				
	Year 2 ONLY: Attach the summary report of the review activity	<input type="checkbox"/>	N/A	N/A	
	Year 4 ONLY: Attach the follow-up report on plan implementation	<input type="checkbox"/>	N/A	N/A	
Part III.A.2 Summary	Provide an evaluation of the Stormwater Management Program according to Part VI.B.3 of the permit.				
	Strengths: Any proposed development or modifications of existing properties must apply to the Town's Architectural Review & Planning Board. The Town is small in size and there are no large size properties available for significant redevelopment projects.				
	Limitations: N/A				
	SWMP revisions implemented to address limitations: N/A				
Part III.A.3	Roadways				
	Report on the litter control program, including the frequency of litter collection, an estimate of the total number of road miles cleaned or amount of area covered by the activities, and an estimate of the quantity of litter collected.				
	<i>Note: If the permittee does not contract activities, delete CONTRACTOR activities.</i>				
	PERMITTEE Litter Control: Frequency of litter collection	12	 Maintenance Log – Catch Basins, Grates, Roadside Ditches	Town Staff (B. Dietrick, W. Songer)	
	PERMITTEE Litter Control: Estimated amount of area maintained (miles)	0.97	Daily Activity	Town Staff	Daily all Town ROW plus trash pickup on FDOT ROW and within Town.
PERMITTEE Litter Control: Estimated amount of litter collected (container gallons)	340	Maintenance Log – Catch Basins, Grates, Roadside Ditches	Town Staff (B. Dietrick, W. Songer)		

SECTION VII. STORMWATER MANAGEMENT PROGRAM (SWMP) SUMMARY TABLE

A.	B.	C.	D.	E.	F.
Permit Citation/ SWMP Element	Permit Requirement/Quantifiable SWMP Activity	Number of Activities Performed	Documentation / Record	Entity Performing the Activity	Comments
	<p>OPTIONAL: If an Adopt-A-Road or similar program is implemented, report the total number of road miles cleaned and an estimate of the quantity of litter collected. If you do not participate in an Adopt-A-Road program, report "0".</p>				
	<p>Trash Pick-up Events: Total miles cleaned</p>	0	N/A	N/A	Did not participate
	<p>Trash Pick-up Events: Estimated amount of litter collected (cy)</p>	0	N/A	N/A	Did not participate
	<p>Adopt-A-Road: Total miles cleaned</p>	0	N/A	N/A	Did not participate
	<p>Adopt-A-Road: Estimated amount of litter collected (cy)</p>	0	N/A	N/A	Did not participate
	<p>Report on the street sweeping program, including the frequency of the sweeping, total miles swept, an estimate of the quantity of sweepings collected, and the total nitrogen and total phosphorus loadings that were removed by the collection of sweepings. If no street sweeping program is implemented, provide the explanation of why not in column F.</p>				
	<p>Frequency of street sweeping</p>	0	N/A	N/A	Town streets do not have curbs and therefore the Town does not have a street sweeping program.
	<p>Total miles swept</p>	0	N/A	N/A	
	<p>Estimated quantity of sweeping material collected (cy / tons)</p>	0	N/A	N/A	
	<p>Total phosphorous loadings removed (pounds)</p>	0	N/A	N/A	
	<p>Total nitrogen loadings removed (pounds)</p>	0	N/A	N/A	
	<p>Report the equipment yards and maintenances shops that support road maintenance activities, and the number of inspections conducted for each facility.</p>				
	<p>Name of Facility</p>	<p>Number of Inspections</p>			
		0	N/A	N/A	No municipal maintenance yards / maintenances shops

SECTION VII. STORMWATER MANAGEMENT PROGRAM (SWMP) SUMMARY TABLE

A.	B.	C.	D.	E.	F.
Permit Citation/ SWMP Element	Permit Requirement/Quantifiable SWMP Activity	Number of Activities Performed	Documentation / Record	Entity Performing the Activity	Comments
Part III.A.3 Summary	Provide an evaluation of the Stormwater Management Program according to Part VI.B.3 of the permit.				
	Strengths: Due to the relatively small area of the Town, all roadways are patrolled and litter collected daily as necessary. None of the streets have curb, and therefore, the Town has no street sweeping program. Resident complaints are addressed immediately.				
	Limitations: None.				
	SWMP revisions implemented to address limitations: N/A				
Part III.A.4	Flood Control Projects				
	Report the total number of flood control projects that were constructed by the permittee during the reporting period and the number of those projects that did NOT include stormwater treatment. The permittee shall provide a list of the projects where stormwater treatment was not included with an explanation for each of why it was not.				
	Report on any stormwater retrofit planning activities and the associated implementation of retrofitting projects to reduce stormwater pollutant loads from existing drainage systems that do not have treatment BMPs.				
	Flood control projects completed during the reporting period	0	N/A	N/A	No flood control projects completed during the reporting period.
	Flood control projects completed that did <u>not</u> include stormwater treatment	N/A	N/A	N/A	
	Stormwater retrofit projects planned/under construction	0	N/A	N/A	No retrofit projects are planned.
	Stormwater retrofit projects completed	0	N/A	N/A	
Part III.A.4 Summary	Provide an evaluation of the Stormwater Management Program according to Part VI.B.3 of the permit.				
	Strengths: There are no large areas of single ownership within the Town and no need for flood control projects.				
	Limitations: None.				
	SWMP revisions implemented to address limitations: N/A				

SECTION VII. STORMWATER MANAGEMENT PROGRAM (SWMP) SUMMARY TABLE

A.	B.	C.	D.	E.	F.
Permit Citation/ SWMP Element	Permit Requirement/Quantifiable SWMP Activity	Number of Activities Performed	Documentation / Record	Entity Performing the Activity	Comments
Part III.A.5	Municipal Waste Treatment, Storage, and Disposal Facilities Not Covered by an NPDES Stormwater Permit				
	Report the applicable facilities and the number of the inspections conducted for each facility.				
	Name of Facility	Number of Inspections			
		0	N/A	N/A	No municipal waste treatment, storage or disposal facilities within Town
Part III.A.5 Summary	Provide an evaluation of the Stormwater Management Program according to Part VI.B.3 of the permit.				
	Strengths: There are no Waste TSD Facilities within the Town.				
	Limitations: None.				
	SWMP revisions implemented to address limitations: N/A				
Part III.A.6	Pesticides, Herbicides, and Fertilizer Application				
	Report the number of permittee personnel applicators and contracted commercial applicators of pesticides and herbicides who are FDACS certified / licensed.				
	Report the number of permittee personnel who have been trained through the Green Industry BMP Program and the number of contracted commercial applicators of fertilizer who are FDACS certified / licensed.				
	PERSONNEL: FDACS public applicators of pesticides/herbicides	0	N/A		Contracted out
	CONTRACTORS: FDACS commercial applicators of pesticides/ herbicides	1	Contractor State Registration	Riley's Spraying Service	
	PERSONNEL: Green Industry BMP Program training completed	0	N/A		
	CONTRACTORS: FDACS certified / licensed applicators of fertilizer	0	N/A		Town does not apply or contract for fertilizer application
	Provide a copy of the adopted ordinance with the Year 2 Annual Report. If this provision is not applicable because the permittee is not within the watershed of a nutrient-impaired water body, indicate that in Column F.				
	Year 2 ONLY: Attach copy of adopted Florida-friendly ordinance	<input type="checkbox"/>	N/A		
	Report on the public education and outreach activities that are performed or sponsored by the permittee within the permittee's jurisdiction to encourage citizens to reduce their use of pesticides, herbicides and fertilizers including the type and number of activities conducted, the type and number of materials distributed, and the number of Web site visits (if applicable). See Joint Report. The public outreach and education plan is carried out as a joint effort by the Palm Beach County Co-Permittees. Please see the Palm Beach County Joint Annual Report for the public education and outreach information.				

SECTION VII. STORMWATER MANAGEMENT PROGRAM (SWMP) SUMMARY TABLE

A.	B.	C.	D.	E.	F.
Permit Citation/ SWMP Element	Permit Requirement/Quantifiable SWMP Activity	Number of Activities Performed	Documentation / Record	Entity Performing the Activity	Comments
Part III.A.6 Summary	Provide an evaluation of the Stormwater Management Program according to Part VI.B.3 of the permit.				
	Strengths: The Town contracts for pesticide treatment at Town Hall but does not operate any facilities requiring herbicide or fertilizer application. The Town has notified the Contractor of the need for Green Industry Program BMP training.				
	Limitations: None.				
	SWMP revisions implemented to address limitations: N/A				
Part III.A.7.a	Illicit Discharges and Improper Disposal — Inspections, Ordinances, and Enforcement Measures				
	Report amendments in Year 4.				
	Year 4 ONLY: Attach a report on amendments to applicable legal authority	<input type="checkbox"/>	N/A		
Part III.A.7.c	Illicit Discharges and Improper Disposal — Investigation of Suspected Illicit Discharges and/or Improper Disposal				
	Report on the proactive inspection program, including the number of inspections conducted by the permittee, the number of illicit activities found, and the number and type of enforcement actions taken.				
	Proactive inspections for suspected illicit discharges	12	Maintenance Log – Catch Basins, Grates, Roadside Ditches	Town Staff (B. Dietrick, W. Songer)	
	Inspections performed by Palm Beach County SQG Program	0	N/A	N/A	No inspections performed by PBC SQG Program
	Illicit discharges found during a proactive inspection	0	Maintenance Log – Catch Basins, Grates, Roadside Ditches	Town Staff (B. Dietrick, W. Songer)	None found
	NOV/WL/citation/fines issued for illicit discharges found during proactive inspection	0	N/A	N/A	No NOVs, etc.
	Year 1 ONLY: Attach the written proactive inspection program plan	N/A	The Town's written proactive inspection program plan has not changed from the previous reporting cycle.		
	Report on the reactive investigation program as it relates to responding to reports of suspected illicit discharges, including the number of reports received, the number of investigations conducted, the number of illicit activities found, and the number and type of enforcement actions taken.				
	Reports of suspected illicit discharges received	0	Daily Customer Service Log	Town Staff	Only complaints of no garbage or no recycling pick- up
	Reactive investigations of reports of suspected illicit discharges etc.	0	N/A	N/A	
	Illicit discharges etc. found during reactive investigation	0	N/A	N/A	
	NOV/WL/citation/fines issued for illicit discharges etc. found during reactive investigation	0	N/A	N/A	

SECTION VII. STORMWATER MANAGEMENT PROGRAM (SWMP) SUMMARY TABLE

A.	B.	C.	D.	E.	F.
Permit Citation/ SWMP Element	Permit Requirement/Quantifiable SWMP Activity	Number of Activities Performed	Documentation / Record	Entity Performing the Activity	Comments
	Report the type of training activities, and the number of permittee personnel and contractors trained (both in-house and outside training) within the reporting year.				
	Personnel trained	2	N/A	N/A	No additional training completed. Current staff members completed initial training from PBC NPDES Steering Committee.
	Contractors trained	0	N/A	N/A	Utilize trained in-house staff or City of Delray Beach Fire Dept.
Part III.A.7.d	Illicit Discharges and Improper Disposal — Spill Prevention and Response				
	Report on the spill prevention and response activities, including the number of spills addressed.				
	Hazardous and non-hazardous material spills responded to	0	N/A	N/A	No spills
	Report the type of training activities, and the number of permittee personnel and contractors trained (both in-house and outside training) within the reporting year.				
	Personnel trained	3	N/A	N/A	No additional training completed. Current staff members were trained.
Contractors trained	0	N/A	N/A	Utilize trained in-house staff or City of Delray Beach Fire Dept.	
Part III.A.7.e	Illicit Discharges and Improper Disposal — Public Reporting				
	Report on the public education and outreach activities that are performed or sponsored by the permittee within the permittee's jurisdiction to encourage the public reporting of suspected illicit discharges and improper disposal of materials, including the type and number of activities conducted, the type and number of materials distributed, and the number of Web site visits (if applicable). See Joint Report. The public outreach and education plan is carried out as a joint effort by the Palm Beach County Co-Permittees. Please see the Palm Beach County Joint Annual Report for the public education and outreach information.				

SECTION VII. STORMWATER MANAGEMENT PROGRAM (SWMP) SUMMARY TABLE

A.	B.	C.	D.	E.	F.
Permit Citation/ SWMP Element	Permit Requirement/Quantifiable SWMP Activity	Number of Activities Performed	Documentation / Record	Entity Performing the Activity	Comments
Part III.A.7.f	Illicit Discharges and Improper Disposal — Oils, Toxics, and Household Hazardous Waste Control				
	Report on the public education and outreach activities that are performed or sponsored by the permittee within the permittee's jurisdiction to encourage the proper use and disposal of oils, toxics, and household hazardous waste, including the type and number of activities conducted, the type and number of materials distributed, the amount of waste collected / recycled / properly disposed, and the number of Web site visits (if applicable). See Joint Report. The public outreach and education plan is carried out as a joint effort by the Palm Beach County Co-Permittees. Please see the Palm Beach County Joint Annual Report for the public education and outreach information.				
Part III.A.7.g	Illicit Discharges and Improper Disposal — Limitation of Sanitary Sewer Seepage				
	Report on the type and number of activities undertaken to reduce or eliminate SSOs and inflow/ infiltration, the number of SSOs or inflow / infiltration incidents found and the number resolved, and the name of the owner of the sanitary sewer system within the permittee's jurisdiction. Report only the SSOs and inflow / infiltration incidents into the MS4.				
	Owner of the sanitary sewer system	Private owners or private septic tank systems			
	Activity to reduce/eliminate SSCs and I&I: (description)	0	N/A	N/A	Town does not maintain or own a sanitary sewer system
	Activity to reduce/eliminate SSCs and I&I: (description)	0	N/A	N/A	Town does not maintain or own a sanitary sewer system
	SSO incidents discovered	0	N/A	N/A	No incidents discovered
	SSO incidents resolved	0	N/A	N/A	
	Inflow / infiltration incidents discovered	0	N/A	N/A	No incidents discovered
	Inflow / infiltration incidents resolved	0	N/A	N/A	
Part III.A.7 Summary	For activities required by Part III.A.7: Provide an evaluation of the Stormwater Management Program according to Part VI.B.3 of the permit.				
	Strengths: The Town proactively inspects all inlets and outfalls monthly and patrols all roadways within the Town on a daily basis. The Town responds to the resident calls immediately.				
	Limitations: None.				
	SWMP Revisions implemented to address limitations: N/A				
Part III.A.8.a	Industrial and High-Risk Runoff — Identification of Priorities and Procedures for Inspections				
	Report on the high risk facilities inventory, including the type and total number of high risk facilities and the number of facilities newly added each year. Report on the high risk facilities inspection program, including the number of inspections conducted and the number and type of enforcement actions taken.				

SECTION VII. STORMWATER MANAGEMENT PROGRAM (SWMP) SUMMARY TABLE

A.	B.		C.		D.	E.	F.
Permit Citation/ SWMP Element	Permit Requirement/Quantifiable SWMP Activity		Number of Activities Performed		Documentation / Record	Entity Performing the Activity	Comments
	Type of Facility	Number of Facilities	Number of Inspections	Enforcement Actions			
	Operating municipal landfills	0	N/A	N/A	N/A	N/A	No landfills in the Town
	Hazardous waste treatment, storage, disposal and recovery (HWTSDR) facilities	0	N/A	N/A	N/A	N/A	No HWTSDR facilities in Town
	EPCRA Title III, Section 313 facilities (TRI)	0	N/A	N/A	N/A	N/A	No EPCRA Title III facilities in Town
	Facilities determined as high risk by the permittee	0	N/A	N/A	N/A	G. Dunham	None found
Part III.A.8.b	Industrial and High-Risk Runoff — Monitoring for High Risk Industries						
	Report the number of high risk facilities sampled.						
	High risk facilities sampled	0	TRI Explorer and RCRA Databases		G. Dunham	No existing or new high risk facilities in Town	
Part III.A.8 Summary	For activities required by Part III.A.8: Provide an evaluation of the Stormwater Management Program according to Part VI.B.3 of the permit.						
	Strengths: There are no high-risk facilities within the Town. This is confirmed annually during this report preparation.						
	Limitations: None.						
	SWMP revisions implemented to address limitations: N/A						
Part III.A.9.a	Construction Site Runoff — Site Planning and Non-Structural and Structural Best Management Practices						
	Report the number of permittee and private pre-construction site plans reviewed for stormwater, erosion, and sedimentation controls, and the number approved.						
	PERMITTEE SITES: Construction site plans reviewed	0	N/A		N/A	No permittee construction sites	
	PERMITTEE SITES: Construction site plans approved	0	N/A		N/A		
	PRIVATE SITES: Construction site plans reviewed	11	2017 Architectural Review & Planning Board File Log		Town Manager		
	PRIVATE SITES: Construction site plans approved	8	2017 Architectural Review & Planning Board File Log		Town Manager	Decisions for 16-12, 16-13 and 17-1 have not yet occurred.	
	Report the number of development permit applicants notified of the ERP and CGP, and the number of applicants who confirmed ERP and CGP coverage.						

SECTION VII. STORMWATER MANAGEMENT PROGRAM (SWMP) SUMMARY TABLE

A.	B.	C.	D.	E.	F.
Permit Citation/ SWMP Element	Permit Requirement/Quantifiable SWMP Activity	Number of Activities Performed	Documentation / Record	Entity Performing the Activity	Comments
	Notified of ERP stormwater permit requirements	0	2017 Architectural Review & Planning Board File Log	Town Manager	No projects met the threshold for ERP
	Confirmed ERP coverage	0	N/A	N/A	
	Notified of CGP stormwater permit requirements	0	2017 Architectural Review & Planning Board File Log	Town Manager	No projects met the threshold for CGP
	Confirmed CGP coverage	0	N/A	N/A	
Part III.A.9.b	Construction Site Runoff — Inspection and Enforcement				
	Report on the inspection program for privately-operated and permittee-operated construction sites, including the number of active construction sites during the reporting year, the number of inspections of active construction sites, the percentage of active construction sites inspected, and the number and type of enforcement actions / referrals taken.				
	PERMITTEE SITES: Active construction sites	0	City of Delray Beach Letter	N/A	No construction sites met threshold for site area disturbance
	PERMITTEE SITES: Pre-, During, and Post inspections of active construction sites for E&S and waste control BMPs	0	City of Delray Beach Letter	N/A	No construction sites met threshold for site area disturbance
	PERMITTEE SITES: Percentage of active construction sites inspected	N/A	City of Delray Beach Letter	N/A	
	PRIVATE SITES: Active construction sites	0	City of Delray Beach Letter	City of Delray Beach Construction Inspection Dept.	No construction sites which discharged to MS4
	PRIVATE SITES: Pre-, During, and Post inspections of active construction sites for E&S and waste control BMPs	0	City of Delray Beach Letter	City of Delray Beach Construction Inspection Dept.	No construction sites met threshold for site area disturbance
	PRIVATE SITES: Percentage of active construction sites inspected	N/A	City of Delray Beach Letter	N/A	
	Enforcement Action	0	N/A		No NOVs, Stop Work Orders, Fines, etc. issued
	Year 1 ONLY: Attach the written construction site inspection program plan	N/A	The Town's written construction site inspection program plan has not changed from the previous reporting cycle.		

SECTION VII. STORMWATER MANAGEMENT PROGRAM (SWMP) SUMMARY TABLE

A.	B.	C.	D.	E.	F.	
Permit Citation/ SWMP Element	Permit Requirement/Quantifiable SWMP Activity	Number of Activities Performed	Documentation / Record	Entity Performing the Activity	Comments	
Part III.A.9.c	Construction Site Runoff — Site Operator Training					
	Report the type of training activities, the number of inspectors, site plan reviewers and site operators trained (both in-house and outside training).					
		DEP Certification	Annual Training			
	Permittee construction site inspectors	0	0	N/A	N/A	1 Town staff attended refresher course in March 2011. Construction site inspections performed by City of Delray Beach staff. Refer to Delray Beach annual report for training of their staff.
	Permittee construction site plan reviewers		0	N/A	N/A	No construction activities during reporting period
Permittee construction site operators		0	N/A	N/A	No construction activities during reporting period	
Part III.A.9 Summary	For activities required by Part III.A.9: Provide an evaluation of the Stormwater Management Program according to Part VI.B.3 of the permit.					
	Strengths: The Town contracts inspections to the City of Delray Beach who inspect and report on 100% of the construction projects. Daily patrols by Town staff ensure all activity is monitored.					
	Limitations: None.					
	SWMP revisions implemented to address limitations: N/A					

SECTION VIII. CHANGES TO THE STORMWATER MANAGEMENT PROGRAM (SWMP) ACTIVITIES (Not Applicable in Year 4)

A.	Permit Citation/ SWMP Element	Proposed Changes to the Stormwater Management Program Activities Established as Specific Requirements Under Part III.A of the Permit (Including the Rationale for the Change) — REQUIRES DEP APPROVAL PRIOR TO CHANGE IF PROPOSING TO REPLACE OR DELETE AN ACTIVITY.
		N/A
B.	Permit Citation/ SWMP Element	Changes to the Stormwater Management Program Activities NOT Established as Specific Requirements Under Part III.A of the Permit (Including the Rationale for the Change)
		N/A

SECTION IX. TMDL Status Report

A.	YEAR 1 Provide a table summarizing the status of the TMDL process. Include a list of prioritized TMDLs and their monitoring and implementation schedule; and include the identification number of the outfall prioritized for TMDL monitoring.								
	WBID Number	Segment/ Waterbody/ Basin	Pollutant of Concern	TMDL DEP / EPA	Percent Reduction (WLA)	Priority Rank	Priority Outfall	Monitoring Summary / BPCP Due Date	Supplemental SWMP Due Date
	N/A			<input type="checkbox"/> / <input type="checkbox"/>		1		(Year 3 AR)	(Year 4 AR; N/A) if BPCP)
				<input type="checkbox"/> / <input type="checkbox"/>					
B.	YEAR 3 and annually thereafter, provide a summary of the estimated load reductions that have occurred for the pollutant(s) of concern being discharged from the MS4 to the TMDL water body during the reporting period and cumulatively since the date the Supplemental SWMP was implemented. Year 3: Submit a Monitoring data summary or BPCP (if applicable). Year 4: Submit a Supplemental SWMP (if applicable).								
	WBID Number	Pollutant of Concern	Monitoring Summary / BPCP Submitted	Supplemental SWMP Submitted	Projected load reductions OR Actual load reductions to date				
	N/A		(Year 3 AR)	(Year 4 AR; N/A if BPCP)					
C.	Provide a brief statement as to the status of TMDL implementation according to Part VIII.B. of the permit (e.g. status of monitoring to validate WLA): <i>No discharge to a TMDL WBID at the time of permit issuance</i>								

Town of Gulf Stream - NPDES Permit No. FLS000018 - Cycle 4, Year 1

Attachment #1 – Maps & Inventories

***NPDES MS4 Drainage System Map
Outfall Inventory
MS4 Pipes/Culverts Inventory
Swale Inventory***

PathName : S:\Standard Maps\Gulfstream\GulfStream_Storm_Map.dwg

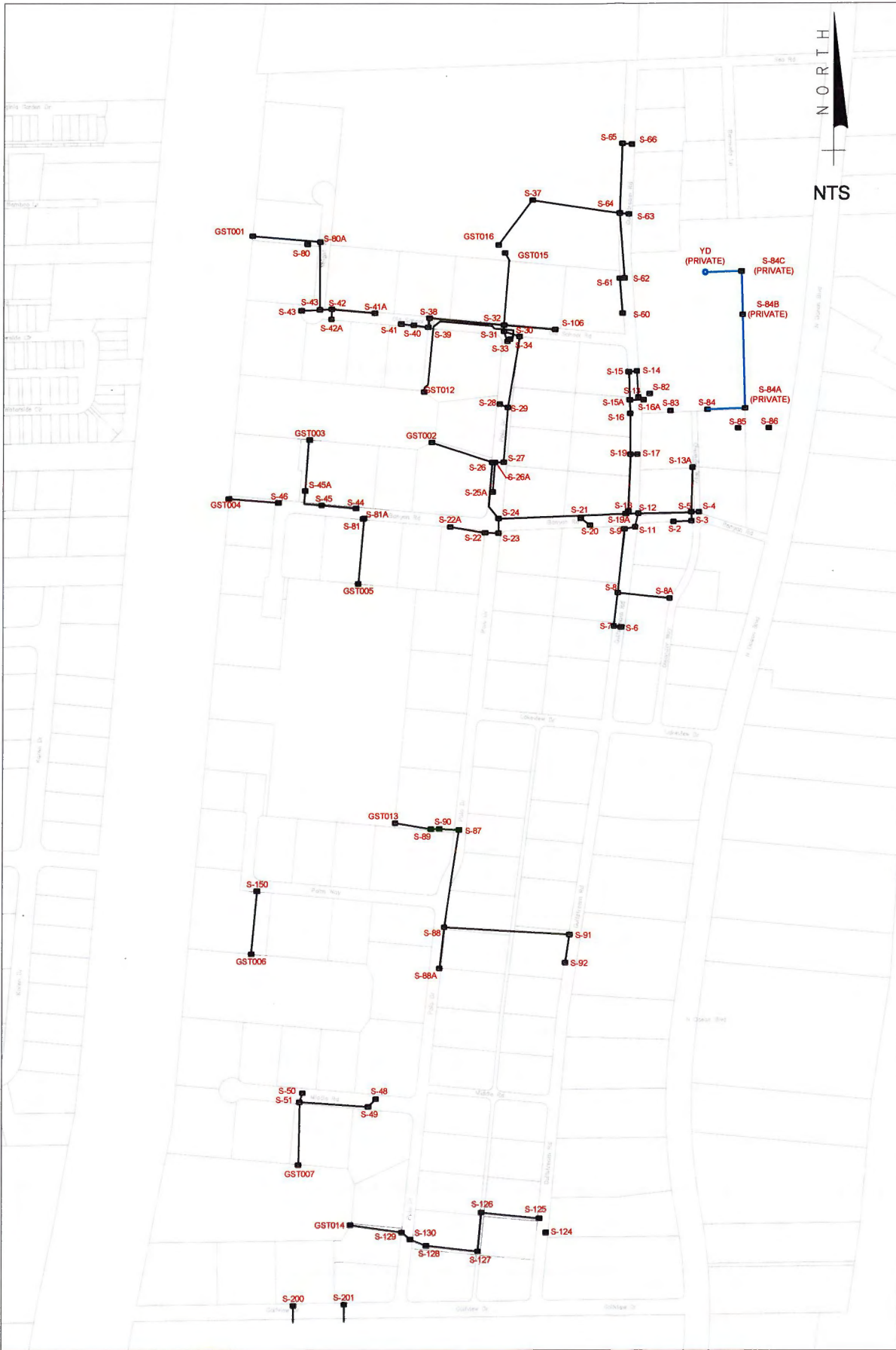

**GULF STREAM
STORMWATER SYSTEM**



GULF STREAM
STORMWATER SYSTEM

Town of Gulf Stream - NPDES Permit No. FLS000018 - Cycle 4, Year 1
Attachment #1 - Outfall Inventory
 September 30, 2017

Outfall Number	Pipe Diameter	Major Outfall*	Weir (Y/N)	Town MS4 Contributing		Location
				(SF)	(AC)	
1	24"	No	N			West from Wright Way
2	24"	No	N			West from Polo Dr between Old School & Banyan
3	12"	No	N			North from Banyan Rd between 1st and 2nd lot from west end
4	12"	No	N			West from west end of Banyan Rd
5	12"	No	N			South from Banyan Rd between 3rd and 4th lot west of Polo Dr
6	18"	No	N			South from west end of Palm Way
7	15"	No	N			South from Middle Rd west of Polo Dr
8	15"	No	N			South from Orchid Lane
9	15"	No	N			North from Indigo Pt
10	18"	No	N			North from Emerald Row
11	18"	No	N			East from east end of Avenue Au Soleil
12	18"	No	N			South from Old School Rd between 1st and 2nd lot west of Polo
13	24"	No	N			West from Polo Dr 1 lot north of Palm Way
14	24"	No	N			West from Polo Dr between Middle Rd and Golfview Dr
15	24"	No	Y			North from Old School Rd, north of PS to golf course
16	18"	No	N			Into southern golf course lake from Gulfstream Rd

* Major outfall: 36" diameter or greater, or outfall which discharges from an area 50 acres or greater, or outfall that discharges from lands zoned industrial

Town of Gulf Stream - NPDES Permit No. FLS000018 - Cycle 4, Year 1
Attachment #1 - MS4 Pipes/Culverts Inventory
September 30, 2017

Diameter/ Material	Length (FT)
Unknown	1,276
4" PVC	30
6"	68
6" CMP	117
6" PVC	357
8" PVC	513
8" Steel	24
10" DIP	68
12"	23
12" CMP	485
12" Steel	140
15"	22
15" CMP	730
15" RCP	323
15" Steel	65
18"	538
18" HDPE	11,203
18" PVC	61
18" Steel	140
24" CMP	480
24" DIP	18
24" HDPE	211
24" PVC	281
TOTAL	17,173