



# Annual Report Form For Individual NPDES Permits For Municipal Separate Storm Sewer Systems (RULE 62-624.600(2), F.A.C.)

- This Annual Report Form must be completed and submitted to the Department to satisfy the annual reporting requirements established in Rule 62-621.600, F.A.C.
- Submit this fully completed and signed form and any REQUIRED attachments by email to the NPDES Stormwater Program Administrator or to the MS4 coordinator (<http://www.dep.state.fl.us/water/stormwater/npdes/contacts.htm>). Files larger than 10MB may be placed on the FTP site at: [ftp://ftp.dep.state.fl.us/pub/NPDES\\_Stormwater/](ftp://ftp.dep.state.fl.us/pub/NPDES_Stormwater/). After uploading files, email the MS4 coordinator or NPDES Program Administrator to notify them the report is ready for downloading; or by mail to the address in the box at right.
- Refer to the Form Instructions for guidance on completing each section.
- **Please print or type information in the appropriate areas below.**

**Submit the form and attachments to:**  
 Florida Department of Environmental Protection  
 Mail Station 3585  
 2600 Blair Stone Road  
 Tallahassee, Florida 32399-2400

**SECTION I. BACKGROUND INFORMATION**

<b>A.</b>	Permittee Name: Town of Lantana		
<b>B.</b>	Permit Name: Palm Beach County MS4		
<b>C.</b>	Permit Number: FLS000018-004		
<b>D.</b>	Annual Report Year: <input checked="" type="checkbox"/> Year 1 <input type="checkbox"/> Year 2 <input type="checkbox"/> Year 3 <input type="checkbox"/> Year 4 <input type="checkbox"/> Year 5 <input type="checkbox"/> Other, specify Year:		
<b>E.</b>	Reporting Time Period (month/year): October / 2016 through September / 2017		
<b>F.</b>	Name of the Responsible Authority: Deborah Manzo		
	Title: Town Manager		
	Mailing Address: 500 Greynolds Circle		
	City: Lantana	Zip Code: 33462	County: Palm Beach
	Telephone Number: 561-540-5000		Fax Number: 561-540-5759
<b>G.</b>	E-mail Address: dmanzo@lantana.org		
	Name of the Designated Stormwater Management Program Contact (if different from Section I.F above): Jerry Darr		
	Title: Assistant Utilities Director		
	Department: Public Utilities		
	Mailing Address: 510 W. Pine Street		
	City: Lantana	Zip Code: 33462	County: Palm Beach
Telephone Number: 561-540-5758		Fax Number: 561-540-5759	
E-mail Address: jdarr@lantana.org			

**SECTION II. MS4 MAJOR OUTFALL INVENTORY (Not Applicable in Year 1)**

<b>A.</b>	Number of outfalls ADDED to the outfall inventory in the current reporting year (insert "0" if none): (Does this number include non-major outfalls? <input type="checkbox"/> Yes <input type="checkbox"/> No <input checked="" type="checkbox"/> Not Applicable)
<b>B.</b>	Number of outfalls REMOVED from the outfall inventory in the current reporting year (insert "0" if none): (Does this number include non-major outfalls? <input type="checkbox"/> Yes <input type="checkbox"/> No <input checked="" type="checkbox"/> Not Applicable)
<b>C.</b>	Is the change in the total number of outfalls due to lands annexed or vacated? <input type="checkbox"/> Yes <input type="checkbox"/> No <input checked="" type="checkbox"/> Not Applicable

**SECTION III. PART V.B. ASSESSMENT PROGRAM**

<b>A.</b>	<p>Provide a brief statement as to the status of water quality monitoring plan implementation. Status may include sampling frequency changes, monitoring location changes, or sampling waiver conditions. <i>DEP Note: If permittee participates in a collaborative monitoring plan, permittee may refer to a joint response as defined by the interlocal agreement.</i></p> <p>Name and date of the approved plan: <i>Current approved plan for the Group Monitoring Plan is September 8, 2016 (with issuance of the Cycle 4 permit). Our newly-developed, individual Assessment Plan was submitted on 9/8/17.</i></p> <p>Status: <i>The Group Monitoring Report is included in the Cycle 4, Year 1 Joint Annual Report. The newly-developed, individual Assessment Plan is awaiting approval by FDEP.</i></p>
<b>B.</b>	<p>Provide a brief discussion of the monitoring and loading results to date which includes a summary of the water quality monitoring data and / or stormwater pollutant loading changes from the reporting year. <i>DEP Note: Results must be specific to the permittee's SWMP.</i></p> <p><i>Please refer to the Cycle 4, Year 1 Joint Annual Report for a summary of the Group's water quality monitoring results for the reporting period. Refer to the Cycle 3, Year 6 Joint Annual Report for proposed pollutant loading analysis changes. The best available information on existing pollutant loading estimates is documented in the Cycle 3, Year 3 Joint Annual Report.</i></p> <p><i>The newly-developed, individual Assessment Plan is under review by FDEP and will be implemented during Year 2 of the permit cycle. Note that in any future reporting year, the Group's water quality monitoring data for the reporting period may not be available for 4 to 6 months after the reporting period has ended. Consequently, any water quality data from the Group Program that is used as part of an individual permittee's Assessment Plan for the reporting period, will be based on the previous year's data.</i></p>
<b>C.</b>	<p>Attach a monitoring data summary as required by the permit. An analysis of the data discussing changes in water quality and/or stormwater pollutant loading from previous reporting years. <i>DEP Note: Analysis must be specific to the permittee's SWMP.</i></p> <p><i>See response for Section III.B., above.</i></p>

**SECTION IV. FISCAL ANALYSIS**

<b>A.</b>	Total expenditures for the NPDES stormwater management program for the current reporting year: \$385,828.00
<b>B.</b>	Total budget for the NPDES stormwater management program for the subsequent reporting year: \$409,000.00
<b>C.</b>	<p>Did the current reporting year resources decrease from the previous year? Y <input type="checkbox"/> / N <input checked="" type="checkbox"/></p> <p>If program resources decreased, provide a discussion of the impacts on the implementation of the SWMP.</p> <p>N/A</p>

**SECTION V. MATERIALS TO BE SUBMITTED WITH THIS ANNUAL REPORT FORM**

Only the following materials are to be submitted to the Department along with this fully completed and signed Annual Report Form (check the appropriate box to indicate whether the item is attached or is not applicable):

Attached	N/A	Required Attachments	Permit Citation	Attachment Number/Title
<input type="checkbox"/>	<input checked="" type="checkbox"/>	Any additional information required to be submitted in this current annual reporting year in accordance with Part III.A of your permit that is not otherwise included in Section VII below.	Part III.A	
<input type="checkbox"/>	<input checked="" type="checkbox"/>	An explanation of why the minimum inspection frequency in Table II.A.1.a. was not met, if applicable.	Part II.A.1	
<input type="checkbox"/>	<input checked="" type="checkbox"/>	A list of the flood control projects that did not include stormwater treatment and an explanation for each of why it did not (if applicable).	Part III.A.4	
<input checked="" type="checkbox"/>	<input type="checkbox"/>	A monitoring data summary as directed in Section III.C above and in accordance with Rule 62-624.600(2)(c), F.A.C.	Part V.B.3	Refer to Joint Report
<input checked="" type="checkbox"/>	<input type="checkbox"/>	YEAR 1 ONLY: An inventory of all known major outfalls and a map depicting the location of the major outfalls (hard copy or CD-ROM) in accordance with Rule 62-624.600(2)(a), F.A.C.	Part III.A.1	Attachment #1: Maps & Inventories (All outfalls inventoried)
<input type="checkbox"/>	<input checked="" type="checkbox"/>	YEAR 2: A summary review of codes and regulations to reduce the stormwater impact from development.	Part III.A.2	
<input type="checkbox"/>	<input checked="" type="checkbox"/>	Year 3 ONLY: The estimates of pollutant loadings and event mean concentrations for each major outfall or each major watershed in accordance with Rule 62-624.600(2)(b), F.A.C.	Part V.A	
<input type="checkbox"/>	<input checked="" type="checkbox"/>	YEAR 3: Summary of TMDL Monitoring Results (if applicable).	Part VIII.B.2	
<input type="checkbox"/>	<input checked="" type="checkbox"/>	YEAR 3: Bacteria Pollution Control Plan (if applicable).	Part VIII.B.3	
<input type="checkbox"/>	<input checked="" type="checkbox"/>	YEAR 4: A follow-up report on plan implementation of changes to codes and regulations to reduce the stormwater impact from development.	Part III.A.2	
<input type="checkbox"/>	<input checked="" type="checkbox"/>	YEAR 4: A report on any amendments to the applicable legal authority (if applicable).	Part III.A.7.a	
<input type="checkbox"/>	<input checked="" type="checkbox"/>	YEAR 4: Permit re-application information in accordance with Rule 62-624.420(2), F.A.C. <ul style="list-style-type: none"> <li>The monitoring plan (with revisions, if applicable).</li> <li>If the total annual pollutant loadings have not decreased over the past two permit cycles, revisions to the SWMP, as appropriate.</li> </ul>	Part V.B.3 Part V.A.3	
<input type="checkbox"/>	<input checked="" type="checkbox"/>	YEAR 4: TMDL Supplemental SWMP (if applicable).	Part VIII.B.3	

**DO NOT SUBMIT ANY OTHER MATERIALS**  
(such as records and logs of activities, monitoring raw data, public outreach materials, etc.)

**SECTION VI. CERTIFICATION STATEMENT AND SIGNATURE**

The Responsible Authority listed in Section I.F above must sign the following certification statement, as per Rule 62-620.305, F.A.C.:

I certify under penalty of law that this document and all attachments were prepared under my direction or supervision in accordance with a system designed to assure that qualified personnel properly gathered and evaluated the information submitted. Based upon my inquiry of the person or persons who manage the system, or those persons directly responsible for gathering the information, the information submitted is, to the best of my knowledge and belief, true, accurate and complete. I am aware that there are significant penalties for submitting false information, including the possibility of fine and imprisonment for knowing violations.

Name of Responsible Authority (type or print): Deborah Manzo

Title: Town Manager

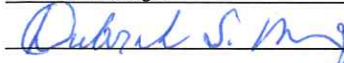
Signature:  Date: 1/25/2018

**SECTION VII. STORMWATER MANAGEMENT PROGRAM (SWMP) SUMMARY TABLE**



A.	B.					C.	D.	E.	F.
Permit Citation/ SWMP Element	Permit Requirement/Quantifiable SWMP Activity					Number of Activities Performed	Documentation / Record	Entity Performing the Activity	Comments
<b>Part III.A.1</b>	<b>Structural Controls and Stormwater Collection Systems Operation</b>								
	Report the current known inventory.								
	Report the number of inspection and maintenance activities conducted for each applicable type of structure included in Table II.A.1.a, and the percentage of the total inventory of each type of structure inspected and maintained.								
	<i>Note: Delete structures that are not in your MS4's inventory. The permittee may choose its own unit of measurement for each structural control to be consistent with the unit of measurement in the documentation. Unit options include: miles, linear feet, acres, etc.</i>								
	<b>Type of Structure</b>	<b>Number of Structures</b>	<b>Number of Inspections</b>	<b>Percent Inspected</b>	<b>Number of Maintenance Activities</b>	<b>Percent Maintained</b>			
	<b>Dry retention systems</b>	4	12	50%	12	50%	Inspection Form for Structural Controls Retention / Detention Pond	Town of Lantana	
	<b>Grass treatment swales (linear feet)</b>	12,980	52	100%	0	N/A	N/A	Republic Services, Inc.	Town hired a private contractor to perform this work.
	<b>Pollution control boxes</b>	2	4	100%	0	N/A	Drainage Inspection & Maintenance Report Form	Town of Lantana	
	<b>Stormwater pump stations</b>	2	4	100%	0	N/A	Drainage Inspection & Maintenance Report Form	Town of Lantana	
<b>Major stormwater outfalls</b>	0	N/A	N/A	N/A	N/A	Drainage Inspection & Maintenance Report Form	Town of Lantana	No major outfalls	

**SECTION VII. STORMWATER MANAGEMENT PROGRAM (SWMP) SUMMARY TABLE**



A.	B.			C.		D.	E.	F.	
Permit Citation/ SWMP Element	Permit Requirement/Quantifiable SWMP Activity			Number of Activities Performed		Documentation / Record	Entity Performing the Activity	Comments	
	<b>Weirs or other control structures</b>	1	0	0%	0	0%	N/A	Town of Lantana	Weir at BMP A was inspected in Cycle 3, Year 3
	<b>MS4 pipes / culverts (linear feet)</b>	12,229	219	30%	97	30%	Drainage Inspection & Maintenance Report Form	Town of Lantana	
	<b>Inlets / catch basins / grates</b>	128	219	80%	97	55%	Drainage Inspection & Maintenance Report Form	Town of Lantana	
	If the minimum inspection frequencies set forth in Table II.A.1.a. were not met, provide as an attachment an explanation of why they were not and a description of the actions that will be taken to ensure that they will be met.				N/A		N/A	N/A	Minimum Inspection Frequencies Met

SECTION VII. STORMWATER MANAGEMENT PROGRAM (SWMP) SUMMARY TABLE					
A.	B.	C.	D.	E.	F.
Permit Citation/ SWMP Element	Permit Requirement/Quantifiable SWMP Activity	Number of Activities Performed	Documentation / Record	Entity Performing the Activity	Comments
Part III.A.1 Summary	Provide an evaluation of the Stormwater Management Program according to Part VI.B.2 of the permit.				
	<b>Strengths: Town completes inspection of 100% of their MS4 inlets and minimum 30% inspections on drainage pipe annually. The dry detention BMP's are regularly inspected and mowed which includes trash pickup.</b>				
	<b>Limitations: Town contracted trash pick-up to Republic Services, Inc. this reporting period. This private contractor did not provide any reporting documentation for trash pick-up.</b>				
	<b>SWMP revisions implemented to address limitations: N/A</b>				
Part III.A.2	<b>Areas of New Development and Significant Redevelopment</b>				
	Report the number of significant development projects, including new and redevelopment, reviewed and approved by the permittee for post-development stormwater considerations.				
	<b>Number of significant development projects reviewed</b>	1	2016 / 2017 Drainage Permit Applications Log	Town Engineer	5 permit applications were reviewed during the reporting and 4 were less than 1 acre.
	<b>Number of significant development projects approved</b>	1	Approval Letter	Town Engineer	WTC Offsite Roads
	Provide in the Year 2 Annual Report the summary report of the review activity. Provide in the Year 4 Annual Report the follow-up report on plan implementation.				
	<b>Year 2 ONLY: Attach the summary report of the review activity</b>	<input type="checkbox"/>	N/A	N/A	
	<b>Year 4 ONLY: Attach the follow-up report on plan implementation</b>	<input type="checkbox"/>	N/A	N/A	
Part III.A.2 Summary	Provide an evaluation of the Stormwater Management Program according to Part VI.B.2 of the permit.				
	<b>Strengths: Any proposed significant redevelopment projects must submit for review and approval to the Town's Plan Review Committee and then to the Town Council. No significant redevelopment projects have been submitted for site plan review during this reporting period.</b>				
	<b>Limitations: None.</b>				
	<b>SWMP revisions implemented to address limitations: N/A</b>				
Part III.A.3	<b>Roadways</b>				
	Report on the litter control program, including the frequency of litter collection, an estimate of the total number of road miles cleaned or amount of area covered by the activities, and an estimate of the quantity of litter collected.				
	<i>Note: If the permittee does not contract activities, delete CONTRACTOR activities.</i>				
	<b>PERMITTEE Litter Control: Frequency of litter collection</b>	0	N/A	N/A	Town hired a private contractor to perform this work.
<b>PERMITTEE Litter Control: Estimated amount of area maintained (If)</b>	0	N/A	N/A	Town hired a	

**SECTION VII. STORMWATER MANAGEMENT PROGRAM (SWMP) SUMMARY TABLE**

A.	B.	C.	D.	E.	F.	
Permit Citation/ SWMP Element	Permit Requirement/Quantifiable SWMP Activity	Number of Activities Performed	Documentation / Record	Entity Performing the Activity	Comments	
	PERMITTEE Litter Control: Estimated amount of litter collected (cy)				private contractor to perform this work.	
		N/A	N/A	N/A	Town hired a private contractor to perform this work.	
	CONTRACTOR Litter Control: Frequency of litter collection	52, weekly		N/A	Republic Services, Inc.	
	CONTRACTOR Litter Control: Estimated amount of area maintained (lf)	32		N/A	Republic Services, Inc.	
	CONTRACTOR Litter Control: Estimated amount of litter collected (cy)	52,991		N/A	Republic Services, Inc.	Average from previous reporting period since no documentation was provided from private contractor.
	OPTIONAL: If an Adopt-A-Road or similar program is implemented, report the total number of road miles cleaned and an estimate of the quantity of litter collected. If you do not participate in an Adopt-A-Road program, report "0".					
	Trash Pick-up Events: Total miles cleaned	1.8	Lantana Coastal Cleanup	Clerk Comptroller of PBC; Keep PBC Beautiful Organization; Town of Lantana	Town participated in the Great American Clean-up on 4/22/17. 46 volunteers walked the Town's beaches collecting trash.	
	Trash Pick-up Events: Estimated amount of litter collected (pounds)	135	Lantana Coastal Cleanup	Clerk Comptroller of PBC; Keep PBC Beautiful Organization; Town of Lantana	Trash collected included plastic bottles, a large wooden crate, foam, plastic bags, bottle caps, etc.	
	Adopt-A-Road: Total miles cleaned	0		N/A	N/A	Did not participate

**SECTION VII. STORMWATER MANAGEMENT PROGRAM (SWMP) SUMMARY TABLE**

A.	B.	C.	D.	E.	F.													
Permit Citation/ SWMP Element	Permit Requirement/Quantifiable SWMP Activity	Number of Activities Performed	Documentation / Record	Entity Performing the Activity	Comments													
	<b>Adopt-A-Road: Estimated amount of litter collected (cy)</b>	N/A	N/A	N/A														
	Report on the street sweeping program, including the frequency of the sweeping, total miles swept, an estimate of the quantity of sweepings collected, and the total nitrogen and total phosphorus loadings that were removed by the collection of sweepings. If no street sweeping program is implemented, provide the explanation of why not in column F.																	
	<table border="1" style="width: 100%; border-collapse: collapse;"> <tr> <td style="width: 50%;"><b>Frequency of street sweeping</b></td> <td style="width: 10%; text-align: center;">0</td> <td colspan="3" rowspan="5" style="width: 30%; vertical-align: top;">  Town does not perform street sweeping. The street sweeping program was suspended due to lack of funding.                 </td> </tr> <tr> <td><b>Total miles swept</b></td> <td style="text-align: center;">0</td> </tr> <tr> <td><b>Estimated quantity of sweeping material collected (cy / tons)</b></td> <td style="text-align: center;">N/A</td> </tr> <tr> <td><b>Total phosphorous loadings removed (pounds)</b></td> <td style="text-align: center;">N/A</td> </tr> <tr> <td><b>Total nitrogen loadings removed (pounds)</b></td> <td style="text-align: center;">N/A</td> </tr> </table>	<b>Frequency of street sweeping</b>	0	 Town does not perform street sweeping. The street sweeping program was suspended due to lack of funding.			<b>Total miles swept</b>	0	<b>Estimated quantity of sweeping material collected (cy / tons)</b>	N/A	<b>Total phosphorous loadings removed (pounds)</b>	N/A	<b>Total nitrogen loadings removed (pounds)</b>	N/A				
<b>Frequency of street sweeping</b>	0	 Town does not perform street sweeping. The street sweeping program was suspended due to lack of funding.																
<b>Total miles swept</b>	0																	
<b>Estimated quantity of sweeping material collected (cy / tons)</b>	N/A																	
<b>Total phosphorous loadings removed (pounds)</b>	N/A																	
<b>Total nitrogen loadings removed (pounds)</b>	N/A																	
	Report the equipment yards and maintenances shops that support road maintenance activities, and the number of inspections conducted for each facility.																	
	<b>Name of Facility</b>	<b>Number of Inspections</b>																
	<b>Name of Facility #1: Municipal Maintenance Yard</b>	48	Municipal Maintenance Yard Inspection Checklist	Public Works / WTP Staff	4 inspectors monitored monthly the general site, painting, vehicle maintenance and above ground storage tank respectively.													





SECTION VII. STORMWATER MANAGEMENT PROGRAM (SWMP) SUMMARY TABLE						
A.	B.	C.	D.	E.	F.	
Permit Citation/ SWMP Element	Permit Requirement/Quantifiable SWMP Activity	Number of Activities Performed	Documentation / Record	Entity Performing the Activity	Comments	
Part III.A.3 Summary	Provide an evaluation of the Stormwater Management Program according to Part VI.B.2 of the permit.					
	<b>Strengths: A majority of the Town's MS4 system drains to roadside swales or dry detention areas which provide treatment of runoff.</b>					
	<b>Limitations: The Town's street sweeping program has been suspended at the Beach Parking Lot and Sportsman's Park due to lack of funding.</b>					
	<b>SWMP revisions implemented to address limitations: The Town has budgeted \$708,916.00 for roadways in fiscal year 2017-2018. The Town will review the budget and consider re-funding the street sweeping program in the next fiscal year.</b>					
Part III.A.4	<b>Flood Control Projects</b>					
	Report the total number of flood control projects that were constructed by the permittee during the reporting period and the number of those projects that did NOT include stormwater treatment. The permittee shall provide a list of the projects where stormwater treatment was not included with an explanation for each of why it was not.					
	Report on any stormwater retrofit planning activities and the associated implementation of retrofitting projects to reduce stormwater pollutant loads from existing drainage systems that do not have treatment BMPs.					
	<b>Flood control projects completed during the reporting period</b>		0	N/A		
	<b>Flood control projects completed that did <u>not</u> include stormwater treatment</b>		N/A	N/A		
	<b>Stormwater retrofit projects planned/under construction</b>		0	N/A		None planned.
	<b>Stormwater retrofit projects completed</b>		0	N/A		
If there were projects that did not include stormwater treatment, provide as an attachment a list of the projects and an explanation for each of why it did not.		N/A	N/A			
Part III.A.4 Summary	Provide an evaluation of the Stormwater Management Program according to Part VI.B.2 of the permit.					
	<b>Strengths: Due to the fact that the Town is small in size and there are not many larger land parcels, there are few flood control projects. The Town therefore can focus on the flood control projects that are planned or underway.</b>					
	<b>Limitations: None.</b>					
	<b>SWMP revisions implemented to address limitations: N/A</b>					

SECTION VII. STORMWATER MANAGEMENT PROGRAM (SWMP) SUMMARY TABLE					
A.	B.	C.	D.	E.	F.
Permit Citation/ SWMP Element	Permit Requirement/Quantifiable SWMP Activity	Number of Activities Performed	Documentation / Record	Entity Performing the Activity	Comments
<b>Part III.A.5</b>	<b>Municipal Waste Treatment, Storage, and Disposal Facilities Not Covered by an NPDES Stormwater Permit</b>				
	Report the applicable facilities and the number of the inspections conducted for each facility.				
	<b>Name of Facility</b>	<b>Number of Inspections</b>			
	<b>Name of Facility #1: Solid Waste Authority Central County Transfer Station</b> 	0	N/A		Transfer station annexed into Town on 10/26/15. This Palm Beach County facility does not discharge to Town's MS4. Refer to County report for inspection activity.
<b>Part III.A.5 Summary</b>	Provide an evaluation of the Stormwater Management Program according to Part VI.B.2 of the permit.				
	<b>Strengths: The Town annexed the Palm Beach County Solid Waste Authority Central Transfer Station property. The site does not discharge to the Town's MS4 and all permit required inspections are performed by Palm Beach County.</b>				
	<b>Limitations: N/A</b>				
	<b>SWMP revisions implemented to address limitations: N/A</b>				
<b>Part III.A.6</b>	<b>Pesticides, Herbicides, and Fertilizer Application</b>				
	Report the number of permittee personnel applicators and contracted commercial applicators of pesticides and herbicides who are FDACS certified / licensed.				
	Report the number of permittee personnel who have been trained through the Green Industry BMP Program and the number of contracted commercial applicators of fertilizer who are FDACS certified / licensed.				
	<b>PERSONNEL: FDACS public applicators of pesticides/herbicides</b>	0	N/A		
	<b>CONTRACTORS: FDACS commercial applicators of pesticides/ herbicides</b>	2	FDACS ID card	Jhonny Arango, Robert Alcantara	
	<b>PERSONNEL: Green Industry BMP Program training completed</b>	0	N/A		
	<b>CONTRACTORS: Green Industry BMP Program training completed</b>	2	Certificate of Training Green Industry BMP	Kenneth Sheppard, Robert Alcantara	
	<b>CONTRACTORS: FDACS certified / licensed applicators of fertilizer</b>	1	FDACS ID Card	Kenneth Sheppard	
	Provide a copy of the adopted ordinance with the Year 2 Annual Report. If this provision is not applicable because the permittee is not within the watershed of a				

SECTION VII. STORMWATER MANAGEMENT PROGRAM (SWMP) SUMMARY TABLE					
A.	B.	C.	D.	E.	F.
Permit Citation/ SWMP Element	Permit Requirement/Quantifiable SWMP Activity	Number of Activities Performed	Documentation / Record	Entity Performing the Activity	Comments
	nutrient-impaired water body, indicate that in Column F.				
	<b>Year 2 ONLY: Attach copy of adopted Florida-friendly ordinance</b>	N/A	N/A		
	Report on the public education and outreach activities that are performed or sponsored by the permittee within the permittee's jurisdiction to encourage citizens to reduce their use of pesticides, herbicides and fertilizers including the type and number of activities conducted, the type and number of materials distributed, and the number of Web site visits (if applicable).				
	<b>Public Education and Outreach Program</b>	The public outreach and education plan is carried out as a joint effort by the Palm Beach County Co-permittees. Please see the Palm Beach County Joint Annual Report for the public education and outreach information.			
<b>Part III.A.6 Summary</b>	Provide an evaluation of the Stormwater Management Program according to Part VI.B.2 of the permit.				
	<b>Strengths: The Town contracts for pesticide treatment at Town Hall, the parks and the recreation center. The Town also contracts for herbicide application at Town facilities. Both contractors have completed Green Industry BMP Program training.</b>				
	<b>Limitations: N/A</b>				
	<b>SWMP revisions implemented to address limitations: N/A</b>				
<b>Part III.A.7.a</b>	<b>Illicit Discharges and Improper Disposal — Inspections, Ordinances, and Enforcement Measures</b>				
	Report amendments in Year 4.				
	<b>Year 4 ONLY: Attach a report on amendments to applicable legal authority</b>	N/A	N/A		
<b>Part III.A.7.c</b>	<b>Illicit Discharges and Improper Disposal — Investigation of Suspected Illicit Discharges and/or Improper Disposal</b>				
	Report on the proactive inspection program, including the number of inspections conducted by the permittee, the number of illicit activities found, and the number and type of enforcement actions taken.				
	<b>Proactive inspections for suspected illicit discharges</b>	1472	Supervisor's Daily Spill Inspection Report, Drainage Inspection & Maintenance Report Form	Public Works & WTP personnel	Maint. Yard inspected monthly, Vehicle Maint., Streets, Grounds, Sports Complex, Facility Maint., Utility Bldg. inspected each weekday.
	<b>Illicit discharges found during a proactive inspection</b>	0	N/A	Public Works & WTP personnel	Town stated that no illicit discharges were found during this reporting period.

**SECTION VII. STORMWATER MANAGEMENT PROGRAM (SWMP) SUMMARY TABLE**

A.	B.	C.	D.	E.	F.
Permit Citation/ SWMP Element	Permit Requirement/Quantifiable SWMP Activity	Number of Activities Performed	Documentation / Record	Entity Performing the Activity	Comments
	<p><b>NOV/WL/citation/fines issued for illicit discharges found during proactive inspection</b></p>	N/A	N/A		
	<p>Report on the reactive investigation program as it relates to responding to reports of suspected illicit discharges, including the number of reports received, the number of investigations conducted, the number of illicit activities found, and the number and type of enforcement actions taken.</p>				
	<p><b>Reports of suspected illicit discharges received</b></p>	0	Telephone Log	Jerry Darr	
	<p><b>Reactive investigations of reports of suspected illicit discharges etc.</b></p>	0	N/A	N/A	
	<p><b>Illicit discharges etc. found during reactive investigation</b></p>	0	N/A	N/A	
	<p><b>NOV/WL/citation/fines issued for illicit discharges etc. found during reactive investigation</b></p>	0	N/A	N/A	
	<p>Report the type of training activities, and the number of permittee personnel and contractors trained (both in-house and outside training) within the reporting year.</p>				
	<p><b>Personnel trained</b></p>	0		0	N/A
	<p><b>Contractors trained</b></p>	0	N/A	N/A	6 Town Staff completed initial training in the previous reporting period.
<p><b>Part III.A.7.d</b></p>	<p><b>Illicit Discharges and Improper Disposal — Spill Prevention and Response</b></p>				
	<p>Report on the spill prevention and response activities, including the number of spills addressed.</p>				
	<p><b>Hazardous and non-hazardous material spills responded to</b></p>	0	Refer to Palm Beach County's annual report	Palm Beach County Fire / Rescue	
	<p>Report the type of training activities, and the number of permittee personnel and contractors trained (both in-house and outside training) within the reporting year.</p>				
	<p><b>Personnel trained</b></p>	0		N/A	N/A
	<p><b>Contractors trained</b></p>	0	N/A	N/A	
<p><b>Part III.A.7.e</b></p>	<p><b>Illicit Discharges and Improper Disposal — Public Reporting</b></p>				
	<p>Report on the public education and outreach activities that are performed or sponsored by the permittee within the permittee's jurisdiction to encourage the public reporting of suspected illicit discharges and improper disposal of materials, including the type and number of activities conducted, the type and number of materials distributed, and the number of Web site visits (if applicable).</p>				
	<p><b>Public Education and Outreach Program</b></p>	<p>The public outreach and education plan is carried out as a joint effort by the Palm Beach County Co-permittees. Please see the Palm Beach County Joint Annual Report for the public education and outreach information.</p>			
<p><b>Part III.A.7.f</b></p>	<p><b>Illicit Discharges and Improper Disposal — Oils, Toxics, and Household Hazardous Waste Control</b></p>				
	<p>Report on the public education and outreach activities that are performed or sponsored by the permittee within the permittee's jurisdiction to encourage the proper use and disposal of oils, toxics, and household hazardous waste, including the type and number of activities conducted, the type and number of materials distributed, the amount of waste collected / recycled / properly disposed, and the number of Web site visits (if applicable).</p>				

SECTION VII. STORMWATER MANAGEMENT PROGRAM (SWMP) SUMMARY TABLE					
A.	B.	C.	D.	E.	F.
Permit Citation/ SWMP Element	Permit Requirement/Quantifiable SWMP Activity	Number of Activities Performed	Documentation / Record	Entity Performing the Activity	Comments
	<b>Public Education and Outreach Program</b>	The public outreach and education plan is carried out as a joint effort by the Palm Beach County Co-permittees. Please see the Palm Beach County Joint Annual Report for the public education and outreach information.			
<b>Part III.A.7.g</b>	<b>Illicit Discharges and Improper Disposal — Limitation of Sanitary Sewer Seepage</b>				
	Report on the type and number of activities undertaken to reduce or eliminate SSOs and inflow/ infiltration, the number of SSOs or inflow / infiltration incidents found and the number resolved, and the name of the owner of the sanitary sewer system within the permittee's jurisdiction. Report only the SSOs and inflow / infiltration incidents into the MS4.				
	<b>Owner of the sanitary sewer system</b>	Town of Lantana			
	<b>Activity to reduce/eliminate SSOs and I&amp;I: Repair / lining of sanitary sewer system (linear feet)</b>	8,702	Town of Lantana P.O. #004211	Private Contractor	The Town contracted out sewer cleaning, lining and inspection of approximately 8,702 LF of sewer pipe, 205 manholes, and 3 sewer laterals during this reporting period.
	<b>SSO incidents discovered</b>	3	PBC Health Dept. Wastewater Spillage Report	Town	10/19/16: Sewer back-up at intersection of S. Lake Dr & Silver Sands Lane; 11/14/16: L.S. failure causing sewer back up at Beach Curve Dr.; 1/20/17: Sewer back-up during cleaning of the gravity main at 601 E. Coast Ave.
	<b>SSO incidents resolved</b>	3	PBC Health Dept. Wastewater Spillage Report	Town	All 3 SSO incidents discovered were resolved on the

SECTION VII. STORMWATER MANAGEMENT PROGRAM (SWMP) SUMMARY TABLE							
A.	B.		C.		D.	E.	F.
Permit Citation/ SWMP Element	Permit Requirement/Quantifiable SWMP Activity		Number of Activities Performed		Documentation / Record	Entity Performing the Activity	Comments
							day of occurrence.
	Inflow / infiltration incidents discovered		0		N/A		
	Inflow / infiltration incidents resolved		0		N/A		
Part III.A.7 Summary	For activities required by Part III.A.7: Provide an evaluation of the Stormwater Management Program according to Part VI.B.2 of the permit.						
	<b>Strengths: The Town proactively inspects inlets, BMPs, and outfalls and patrols roadways within the Town on a regular basis. The zoning for commercial and industrial uses is concentrated in a few locations and the Town field staff is alert to look for illicit discharges. The Town has an established telephone hotline and information on its website for resident reporting of illicit connections. The RCRAInfo, TRIS and CERCLIS databases are checked annually.</b>						
	<b>Limitations: None.</b>						
	<b>SWMP Revisions implemented to address limitations: N/A</b>						
Part III.A.8.a	<b>Industrial and High-Risk Runoff — Identification of Priorities and Procedures for Inspections</b>						
	Report on the high-risk facilities inventory, including the type and total number of high risk facilities and the number of facilities newly added each year. Report on the high-risk facilities inspection program, including the number of inspections conducted and the number and type of enforcement actions taken.						
	<b>Type of Facility</b>	<b>Number of Facilities</b>	<b>Number of Inspections</b>	<b>Enforcement Actions</b>			
	Operating municipal landfills	0	0	N/A	N/A	N/A	No operating municipal landfill facilities in Town
	Hazardous waste treatment, storage, disposal and recovery (HWTSDR) facilities	0	0	N/A	N/A	Palm Beach County	PBCo SWA Central Transfer Facility property annexed into Town boundary but does not discharge to Town's MS4.
	EPCRA Title III, Section 313 facilities (TRI)	0	0	N/A	N/A	N/A	No Section 313 facilities identified in Town
	Facilities determined as high risk by the permittee	0	0	N/A	N/A	Utilities & Public Works Staff	None found

<b>SECTION VII. STORMWATER MANAGEMENT PROGRAM (SWMP) SUMMARY TABLE</b>					
<b>A.</b>	<b>B.</b>	<b>C.</b>	<b>D.</b>	<b>E.</b>	<b>F.</b>
<b>Permit Citation/ SWMP Element</b>	<b>Permit Requirement/Quantifiable SWMP Activity</b>	<b>Number of Activities Performed</b>	<b>Documentation / Record</b>	<b>Entity Performing the Activity</b>	<b>Comments</b>
<b>Part III.A.8.b</b>	<b>Industrial and High-Risk Runoff — Monitoring for High Risk Industries</b>				
	Report the number of high risk facilities sampled.				
	<b>High risk facilities sampled</b>	0	RCRAInfo, TRI database, and CERCLIS database	N/A	PBCo SWA Central Transfer Facility property annexed into Town boundary but does not discharge to Town's MS4.
<b>Part III.A.8 Summary</b>	Provide an evaluation of the Stormwater Management Program according to Part VI.B.2 of the permit.				
	<b>Strengths: The only High Risk Facility is the recently annexed Central Transfer Station which does not connect to the Town's MS4. Confirmation of any additional High Risk Facilities being added to the MS4 is confirmed annually during the preparation of the annual report.</b>				
	<b>Limitations: None.</b>				
	<b>SWMP revisions implemented to address limitations: N/A</b>				
<b>Part III.A.9.a</b>	<b>Construction Site Runoff — Site Planning and Non-Structural and Structural Best Management Practices</b>				
	Report the number of permittee and private pre-construction site plans reviewed for stormwater, erosion, and sedimentation controls, and the number approved.				
	<b>PERMITTEE SITES: Construction site plans reviewed</b>	3	Construction Drawings	Town Staff	Intracoastal Waterway Water Main Subaqueous Crossing; S. Atlantic Drive Water Main Replacement; S. Lake Drive Force Main Replacement / S. 13 <sup>th</sup> Place Water Main Replacement
	<b>PERMITTEE SITES: Construction site plans approved</b>	2	Construction Contract	Town Staff	Intracoastal Waterway Water Main Subaqueous Crossing; S. Atlantic Drive Water Main Replacement

<b>SECTION VII. STORMWATER MANAGEMENT PROGRAM (SWMP) SUMMARY TABLE</b>						
<b>A.</b>	<b>B.</b>	<b>C.</b>	<b>D.</b>	<b>E.</b>	<b>F.</b>	
<b>Permit Citation/ SWMP Element</b>	<b>Permit Requirement/Quantifiable SWMP Activity</b>	<b>Number of Activities Performed</b>	<b>Documentation / Record</b>	<b>Entity Performing the Activity</b>	<b>Comments</b>	
	<b>PRIVATE SITES: Construction site plans reviewed</b>	5	2016/2017 Drainage Permit Applications Log	Town Building Dept., PRC and Town Engineer		
	<b>PRIVATE SITES: Construction site plans approved</b>	4	2016/2017 Drainage Permit Applications Log	Town Building Dept., PRC and Town Engineer		
	Report the number of development permit applicants notified of the ERP and CGP, and the number of applicants who confirmed ERP and CGP coverage.					
	<b>Notified of ERP stormwater permit requirements</b>	1	2016/2017 Drainage Permit Applications Log	Town Engineer	WTC Offsite Roads	
	<b>Confirmed ERP coverage</b>	0	2016/2017 Drainage Permit Applications Log	Town Engineer	Construction has not begun on the WTC Offsite Roads project.	
	<b>Notified of CGP stormwater permit requirements</b>	1	2016/2017 Drainage Permit Applications Log	Town Engineer	WTC Offsite Roads	
	<b>Confirmed CGP coverage</b>	0	2016/2017 Drainage Permit Applications Log	Town Engineer	Construction has not begun on the WTC Offsite Roads project.	
	<b>Part III.A.9.b</b>	<b>Construction Site Runoff — Inspection and Enforcement</b>				
	Report on the inspection program for privately-operated and permittee-operated construction sites, including the number of active construction sites during the reporting year, the number of inspections of active construction sites, the percentage of active construction sites inspected, and the number and type of enforcement actions / referrals taken.					
		<b>PERMITTEE SITES: Active construction sites</b>	0	N/A	N/A	Notice to Proceed has not been issued for the Intracoastal





SECTION VII. STORMWATER MANAGEMENT PROGRAM (SWMP) SUMMARY TABLE					
A.	B.	C.	D.	E.	F.
Permit Citation/ SWMP Element	Permit Requirement/Quantifiable SWMP Activity	Number of Activities Performed	Documentation / Record	Entity Performing the Activity	Comments
Part III.A.9.c	<b>Construction Site Runoff — Site Operator Training</b>				
	Report the type of training activities, the number of inspectors, site plan reviewers and site operators trained (both in-house and outside training).				
		DEP Certification	Annual Training		
	Permittee construction site inspectors	0	1	 Sign-In Sheet	Steering Committee March 15, 2017
	Permittee construction site plan reviewers		0	N/A	N/A
	Permittee construction site operators		0	N/A	N/A
Part III.A.9 Summary	Provide an evaluation of the Stormwater Management Program according to Part VI.B.2 of the permit.				
	<b>Strengths: The site inspectors are certified / trained and regularly inspect all construction sites. The proper forms are completed.</b>				
	<b>Limitations: Better follow-up by inspectors to check on identified deficiencies of Contractor BMPs.</b>				
	<b>SWMP revisions implemented to address limitations: Town site inspectors are ensuring a follow-up inspection is performed until the deficiencies are addressed.</b>				

SECTION VIII. CHANGES TO THE STORMWATER MANAGEMENT PROGRAM (SWMP) ACTIVITIES (Not Applicable in Year 4)		
A.	Permit Citation/ SWMP Element	Proposed Changes to the Stormwater Management Program Activities Established as Specific Requirements Under Part III.A of the Permit (Including the Rationale for the Change) — REQUIRES DEP APPROVAL PRIOR TO CHANGE IF PROPOSING TO REPLACE OR DELETE AN ACTIVITY.
		N/A
B.	Permit Citation/ SWMP Element	Changes to the Stormwater Management Program Activities NOT Established as Specific Requirements Under Part III.A of the Permit (Including the Rationale for the Change)
		N/A

**SECTION IX. TMDL Status Report**

<b>A.</b>	YEAR 1 Provide a table summarizing the status of the TMDL process. Include a list of prioritized TMDLs and their monitoring and implementation schedule; and include the Identification number of the outfall prioritized for TMDL monitoring.								
	WBID Number	Segment/ Waterbody/ Basin	Pollutant of Concern	TMDL DEP / EPA	Percent Reduction (WLA)	Priority Rank	Priority Outfall	Monitoring Summary / BPCP Due Date	Supplemental SWMP Due Date
	N/A			<input type="checkbox"/> / <input type="checkbox"/>		1		(Year 3 AR)	(Year 4 AR; N/A) if BPCP)
				<input type="checkbox"/> / <input type="checkbox"/>					
<b>B.</b>	YEAR 3 and annually thereafter, provide a summary of the estimated load reductions that have occurred for the pollutant(s) of concern being discharged from the MS4 to the TMDL water body during the reporting period and cumulatively since the date the Supplemental SWMP was implemented.  Year 3: Submit a Monitoring data summary or BPCP (if applicable). Year 4: Submit a Supplemental SWMP (if applicable).								
	WBID Number	Pollutant of Concern	Monitoring Summary / BPCP Submitted	Supplemental SWMP Submitted	Projected load reductions OR Actual load reductions to date				
	N/A		(Year 3 AR)	(Year 4 AR; N/A if BPCP)					
<b>C.</b>	Provide a brief statement as to the status of TMDL implementation according to Part VIII.B of the permit (e.g. status of monitoring to validate WLA):  <i>No discharge to a TMDL WBID at the time of permit issuance</i>								

*Town of Lantana - NPDES Permit No. FLS000018 - Cycle 4, Year 1*

**Attachment #1 – Maps & Inventories**

**NPDES MS4 Drainage System Map  
Outfall Inventory  
MS4 Pipes/Culverts Inventory  
Swale Inventory**



User Name: 76944p Date: Time: Fri, 06 Oct 2017 - 10:48am Path: Name: S:\Standard Maps\Lantana\Drainage Map\NPDES MS4 Drainage Map.dwg

Outfall Number	Town MS4 Contributing Area (SF)	Non-Town MS4 Contributing Area (SF)
1	128,000	60,000
2	272,000	60,000
3		634,200
4	71,200	356,000
5		64,000
6	603,300	
7	358,500	
8	228,000	
9	390,000	
10	492,500	
11	56,400	
12	96,000	
13	142,500	
14	153,900	
15	460,000	
16	50,800	
17	103,237	
18		9,450

BMP Number	Town MS4 Contributing Area (SF)	Non-Town MS4 Contributing Area (SF)
A	716,700	382,800
B		
C	1,157,200	
D	313,000	
E	37,500	
F	566,280	

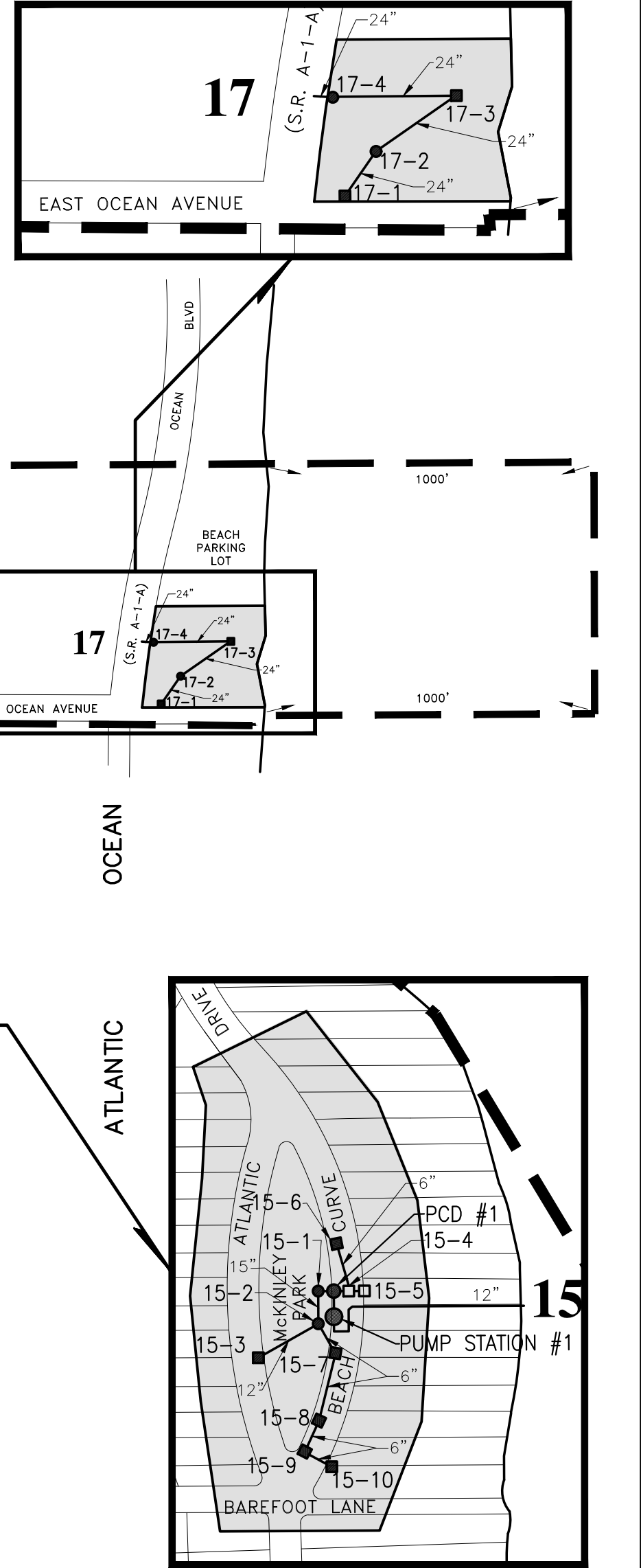
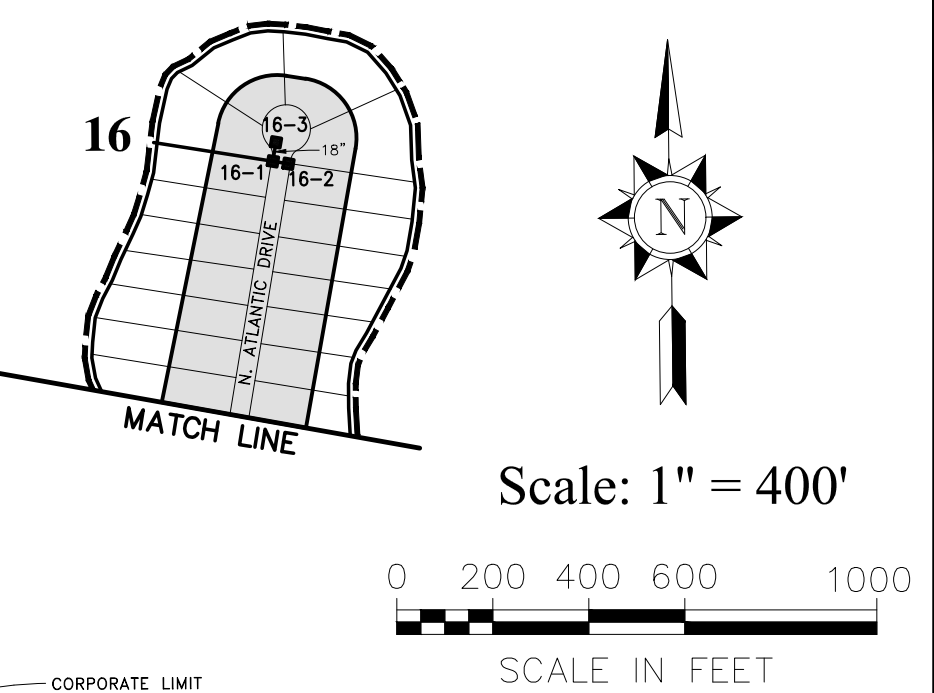
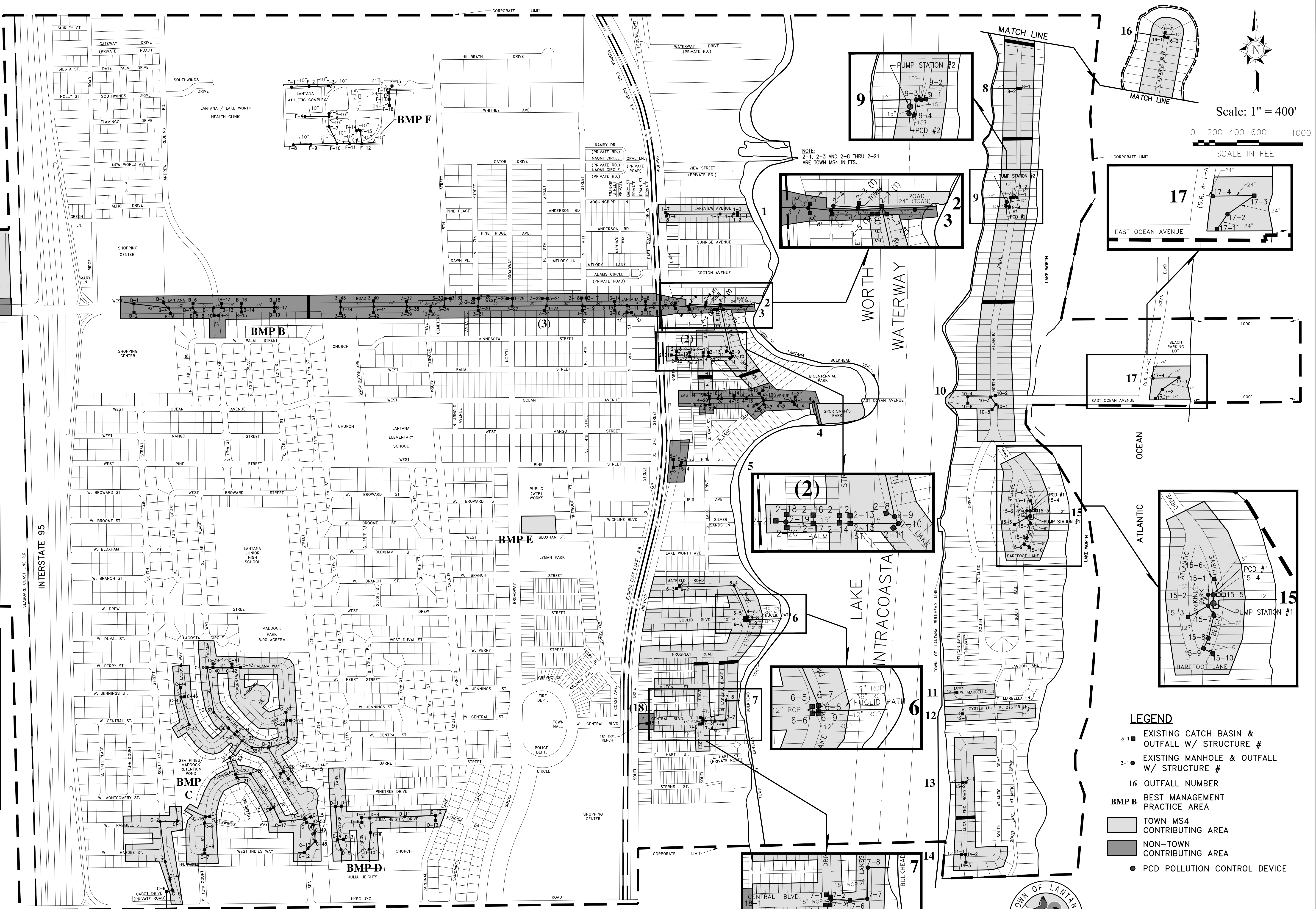

- LEGEND**
- 3-1 ■ EXISTING CATCH BASIN & OUTFALL W/ STRUCTURE #
  - 3-1 ● EXISTING MANHOLE & OUTFALL W/ STRUCTURE #
  - 16 OUTFALL NUMBER
  - BMP B BEST MANAGEMENT PRACTICE AREA
  - TOWN MS4 CONTRIBUTING AREA
  - NON-TOWN CONTRIBUTING AREA
  - PCD POLLUTION CONTROL DEVICE

NPDES MS4 DRAINAGE SYSTEM MAP  
UPDATED SEPTEMBER 2016

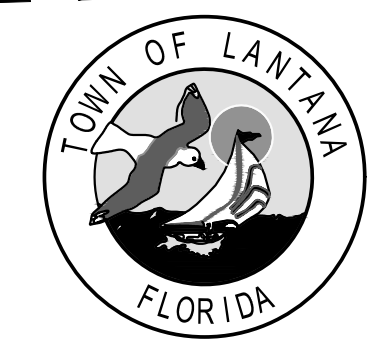

TOWN OF LANTANA



**Town of Lantana**  
**Outfall Inventory**  
September 30, 2017

Outfall Number	Pipe Diameter	Major Outfall	Weir	Town MS4 Contributing Area		Non-Town MS4 Contributing Area		Non-Town Entity
				(SF)	(AC)	(SF)	(AC)	
1	18"	No	No	128,000	2.9			
2	24"	No	No	272,000	6.2	60,000	1.4	(Palm Beach County)
3	36"	No	unknown			634,200	14.6	(Palm Beach County)
4	30" RCP	No	No	71,200	1.6	356,000	8.2	(Palm Beach County)
5	15" RCP	No	No			64,000	1.5	(State of Florida DOT)
6	24" RCP	No	No	603,300	13.8			
7	18" RCP	No	No	358,500	8.2			
8	21"	No	No	228,000	5.2			
9	12" (PS #2)	No	No	390,000	9.0			
10	No outfall found		No	492,500	11.3			
11	15"	No	No	56,400	1.3			
12	18"	No	No	96,000	2.2			
13	24"	No	No	142,500	3.3			
14	15" RCP	No	No	153,900	3.5			
15	12" (PS #1)	No	No	460,000	10.6			
16	unknown	No	No	50,800	1.2			
17	24"	No	No	47,045	1.1			

Major outfall: 36" diameter or greater, or outfall which discharges from an area 50 acres or greater, or outfall that discharges from lands zoned industrial



**Town of Lantana**  
**Swale Inventory**  
 September 30, 2017

Outfall # or BMP	Street Location	Swale (LF)
1	Lakeview	130
2	N. Lake Drive	190
	Palm St	100
	N. Oak St	130
3	N/A Palm Beach County outfall	-
4	E. Ocean Ave.	0
5	Pine St. @ Dixie Hwy - FDOT outfall	-
6	Lake Dr	920
	Euclid Blvd	1030
	Mayfield Rd	610
7	Central Blvd	800
	Milton St	150
	S. Lakeside	60
	Lake Dr	450
8	Atlantic Dr	860
9	Included in #8	-
10	Included in #8	-
11	Marabella Lane	0
12	Oyster Ln	160
13	Lands End/S. Atlantic Dr	360
14	Included in #13	-
15	Beach Curve Dr.	0
16	Included in #8	-
17	Beach Parking Lot	0
A	High Ridge Rd	30
B	Lantana Rd	100
C	Trammell St	350
	Hardee St	460
	S. 14th	300
	W. Indies Way	510
	Tradewinds Way	330
	Caribbean Way	360
	Sea Pines Way	1130
	Palama Way	1700
	Wynndale Way	770
	Wynnwood Cir	210
	Lacosta Way	420
D	Skylark Ln	460
	Julia Heights Dr	180
	Irl's Ridge Way	40
E	WTP - Pine St.	0
F	Lantana Sports Park	0